

UK Product Range

April 2024

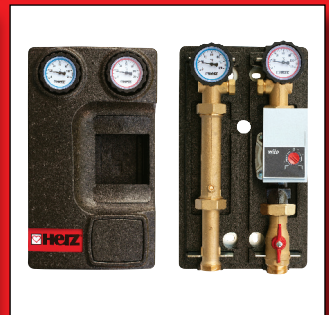

HERZ Valves UK Ltd.

Unit 2B Centurion Business Park, Sturrock Way,

Bretton, Peterborough PE3 8YF

Telephone: 01733 300330

E-mail: sales@herzvalves.com

www.herzvalves.com

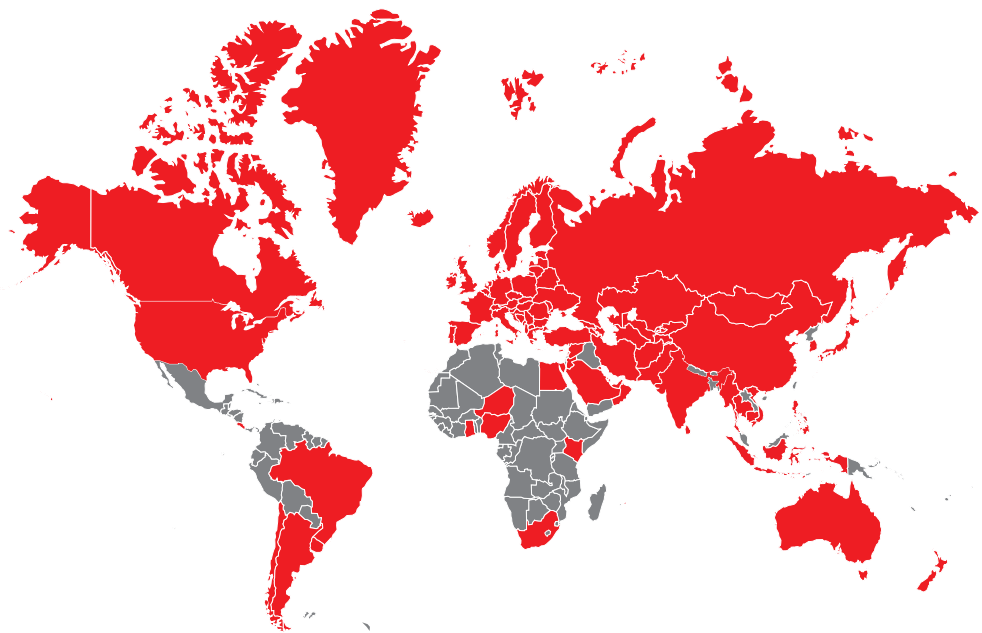

This product guide is not a fully comprehensive list of Herz products but simply a guide to products stocked for the UK market. The full range of products can be found on the Herz UK website.

TABLE OF CONTENTS

1. BALANCING VALVES

• Commissioning Valves	Page 4
• Differential Pressure Control Valves	Page 8
• Pressure Independent Control Valves	Page 11
• Preassembled Valve Configuration for Terminal Units	Page 16
• Accessories	Page 20

2. GENERAL VALVES

• Ball Valves	Page 22
• Gate Valves	Page 25
• Butterfly Valves	Page 28
• Strainers	Page 30
• Check Valves	Page 31
• Drain Valves, Air Elimination	Page 33
• Differential Pressure Overflow Valves	Page 35
• Pressure Relief Safety Valves	Page 35
• Gas Valves	Page 36
• Pressfit Valves	Page 37

3. TEMPERATURE CONTROL

• 2, 3 & 4 Port Control Valves	Page 40
• Actuators	Page 11, 13, 15 & 44
• Room Temperature Controllers	Page 44, 45

4. DOMESTIC WATER SERVICES

• Isolation Valves	Page 46
• Thermal Balancing Valves	Page 48
• Thermostatic Mixing Valves	Page 49
• Pressure Reducing Valves	Page 50
• Check Valves	Page 52
• Strainers	Page 54
• Solenoid Valves	Page 55

5. RADIATOR VALVES

• Thermostatic Heads	Page 56
• Thermostatic Valves	Page 58
• Presettable Valves	Page 59
• Single Pipe Valves	Page 60
• Domestic Bi-Directional Radiator Valves	Page 61
• Lockshield Return Valves	Page 62
• Manual Radiator Valves	Page 64
• LST Kits	Page 65
• HERZ 2000	Page 65
• Deluxe Valves	Page 66
• Pressure Independent Radiator Valves	Page 67
• Accessories	Page 67

6. DISTRIBUTION SYSTEMS

• Heat Interface Units	Page 68
• Pumpfix	Page 72
• Connections	Page 74
• Pressurisation Unit	Page 76
• Substations	Page 76
• Commissioning Centres	Page 77

1. BALANCING VALVES

FODRV Commissioning Valve

4017 M

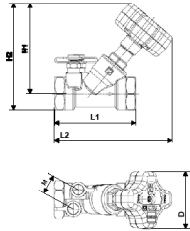

Technical data:

- BS 7350
- Body material DZR
- Max operating pressure: 20 bar
- Max operating temperature: 130 °C
- Connection thread: ISO 228-1



Part number	DN	L1	L2	H1	H2	M	D	Kvs valve	Kvs Orifice
1 4017 11	15 LF	83	129	96	109	25	70	0.46	0.48
1 4017 21	15 MF	83	129	96	109	25	70	0.88	0.97
1 4017 01	15	83	129	96	109	25	70	2.00	1.95
1 4017 02	20	91	135	99	115	25	70	3.60	3.95
1 4017 03	25	110	146	109	130	25	70	6.50	7.90
1 4017 04	32	122	159	117	142	25	70	13.30	15.75
1 4017 05	40	135	178	136	163	25	70	18.50	21.50
1 4017 06	50	164	197	140	175	25	70	33.00	46.70

Double Regulating Valve (DRV)

4017 R

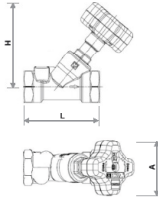

Technical data:

- BS 7350
- Body material DZR
- Max operating pressure: 20 bar
- Max operating temperature: 130 °C
- Connection thread: ISO 228-1



Part number	DN	A	L	H	Kvs valve
1 4017 61	15	70	83	96	2.00
1 4017 62	20	70	91	99	3.60
1 4017 63	25	70	110	109	6.50
1 4017 64	32	70	122	117	13.30
1 4017 65	40	70	135	136	18.50
1 4017 66	50	70	164	140	33.00



Valve Sizing Rule of Thumb 4017

Part number	DN	Kvs Value	Flowrate l/s @ Signal 1 kPa	Flowrate l/s @ Signal 4.7 kPa	Flowrate l/s @ Signal 10 kPa	Flowrate l/s @ Velocity 1.15 m/s
1 4017 11	15 LF	0.48	0.013	0.029	0.042	-
1 4017 21	15 MF	0.97	0.027	0.058	0.085	-
1 4017 01	15	1.95	0.054	0.117	0.171	-
1 4017 02	20	3.95	0.110	0.238	0.347	-
1 4017 03	25	7.9	0.219	0.476	-	0.678
1 4017 04	32	15.75	0.438	0.948	-	1.177
1 4017 05	40	21.5	0.597	1.295	-	1.593
1 4017 06	50	46.7	1.297	2.812	-	2.547

VODRV Commissioning Valve

4217 GM STRÖMAX

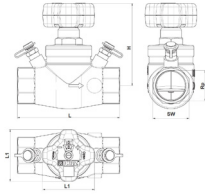

Technical data:

- Body material DZR
- Max operating pressure: 16 bar
- Max operating temperature: 130°C up to DN32, 110°C from DN40
- Connection thread: ISO 228-1

Part number	DN	Rp	L	L1	H	SW	Kvs
1 4217 30	15 LF	½	100	71	97	27	0.93
1 4217 31	15 MF	½	100	71	97	27	3.49
1 4217 01	15	½	100	71	97	27	6.05
1 4217 32	20	¾	100	71	97	32	6.11
1 4217 33	25	1	120	71	107	41	9.22
1 4217 34	32	1¼	140	71	112	50	18.83
1 4217 35	40	1½	150	71	112	55	23.29
1 4217 36	50	2	165	110	136	70	35.26
1 4217 07	65	2½	190	110	141	85	52.11
1 4217 08	80	3	210	110	142	100	76.10

Metering Station

4000

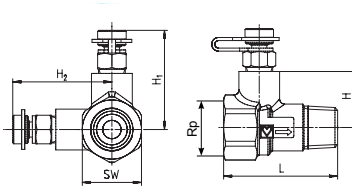

Technical data:

- BS 7350
- Body material DZR
- Max operating pressure: 20 bar
- Max operating temperature: 130°C up to DN32, 110°C from DN40
- Min operating temperature: -20 °C
- Connection thread: ISO 228-1

Part number	DN	R & Rp	L	H	H1 & H2	SW	Kvs
1 4000 11	15 LF	½	56	27.5	52	29	0.55
1 4000 21	15 MF	½	56	27.5	52	29	1.10
1 4000 01	15	½	56	27.5	52	29	2.20
1 4000 02	20	¾	58	30	54.5	36	4.25
1 4000 03	25	1	64	33	57.5	43	8.60
1 4000 04	32	1¼	72	38.5	63	53	15.90
1 4000 05	40	1½	72	40	64.5	61	23.70
1 4000 06	50	2	80	45	69.5	72	48.00

Valve Sizing Rule of Thumb 4000

Part number	DN	Kvs Value	Flowrate l/s @ Signal 1 kPa	Flowrate l/s @ Signal 4.7 kPa	Flowrate l/s @ Signal 10 kPa	Flowrate l/s @ Velocity 1.15 m/s
1 4000 11	15 LF	0.55	0.015	0.033	0.048	-
1 4000 21	15 MF	1.1	0.031	0.066	0.097	-
1 4000 01	15	2.2	0.061	0.132	0.193	-
1 4000 02	20	4.25	0.118	0.256	0.373	-
1 4000 03	25	8.6	0.239	0.518	-	0.678
1 4000 04	32	15.9	0.442	0.958	-	1.177
1 4000 05	40	23.7	0.658	1.427	-	1.593
1 4000 06	50	48	1.333	2.891	-	2.547

1. BALANCING VALVES

Flanged Commissioning Set

4218 CS



Technical data:

- BS 7350
- Body material Cast Iron
- Orifice material Stainless Steel
- Max operating pressure: 16 bar
- Max operating temperature: 120 °C up to DN200, 110°C from DN250
- Min operating temperature: -10 °C
- End flange: BS EN 1092-2 PN16

Part number	DN	Kvs
1 4218 81CS	65	100.7
1 4218 82CS	80	133.6
1 4218 83CS	100	237.7
1 4218 84CS	125	339
1 4218 85CS	150	511
1 4218 86CS	200	858
1 4218 87CS	250	1235
1 4218 88CS	300	1793

Orifice Plate

HV2740

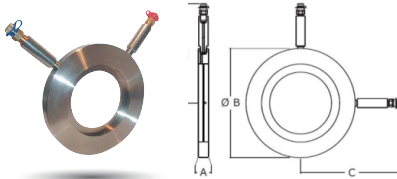

Technical data:

- BS 7350
- Orifice material Stainless Steel
- Max operating pressure: 16 bar
- Max operating temperature: 120 °C
- Min operating temperature: -10 °C

Part number	DN	A	B	C	kvs
HV2740-07	65	20	129	158	100.7
HV2740-08	80	20	144	166	133.6
HV2740-09	100	20	164	176	237.7
HV2740-10	125	20	194	191	339
HV2740-11	150	20	220	204	511
HV2740-12	200	20	275	232	858
HV2740-13	250	20	331	258	1235
HV2740-14	300	20	386	287	1793

Valve Sizing Rule of Thumb 4218 & HV2740

Part number	DN	Kvs Value	Flowrate l/s @ Signal 1 kPa	Flowrate l/s @ Signal 4.7 kPa	Flowrate l/s @ Signal 10 kPa	Flowrate l/s @ Velocity 1.15 m/s
1 4218 81CS	65	100.7	2.797	6.064	8.846	-
1 4218 82CS	80	133.6	3.717	8.058	11.753	-
1 4218 83CS	100	237.7	6.603	14.314	20.880	-
1 4218 84CS	125	339	9.417	20.415	29.778	-
1 4218 85CS	150	511	14.194	30.773	44.887	-
1 4218 86CS	200	858	23.833	51.669	75.368	-
1 4218 87CS	250	1235	34.306	74.373	108.484	-
1 4218 88CS	300	1793	49.806	107.976	157.499	-

Flanged Double Regulating Valve

4218 GF

**Technical data:**

- Body material Cast Iron
- Max operating pressure: 16 bar
- Max operating temperature: 110 °C
- Min operating temperature: -10 °C
- End flange: BS EN 1092-2 PN16

Part number	DN	L	H1	H2	D	Kvs
1 4218 81	65	290	186	280	150	67
1 4218 82	80	310	208	308	175	107
1 4218 83	100	350	235	345	175	169
1 4218 84	125	400	260	385	265	256
1 4218 85	150	480	308	451	265	390
1 4218 86	200	600	449	619	450	676
1 4218 87	250	730	503	705	450	1083
1 4218 88	300	852	562	842	450	1785

1. BALANCING VALVES

Differential Pressure Control Valve

4002

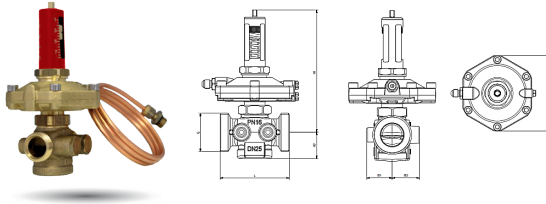

Technical data:

- Body material DZR
- Max operating pressure: 16 bar
- Max operating temperature: 130 °C up to DN32, 110 °C from DN40
- Min operating temperature: -20 °C
- Max differential pressure: 4 bar
- Connection thread: ISO 228-1
- DN15 & 20 Eurocone, DN25-50 flat seal

Connections to be ordered separately see page 11



Part number	Regulating range	DN	G	L	H1	H2	B	B1	B2	Kvs
1 4002 41	5-30 kPa	15	G ¾	66	133	28	95	26	29	2.66
1 4002 42	5-30 kPa	20	G 1	76	134	29	95	28	30	4.36
1 4002 43	5-30 kPa	25	G 1¼	76	134	29	95	28	30	5.38
1 4002 44	5-30 kPa	32	G 1½	114	150	47	95	32	32	9.48
1 4002 45	5-30 kPa	40	G 1¾	132	160	55	95	41	41	14.95
1 4002 46	5-30 kPa	50	G 2 ¾	140	160	55	94	41	41	14.95
1 4002 61	25-60 kPa	15	G ¾	66	133	28	95	26	29	2.66
1 4002 62	25-60 kPa	20	G 1	76	134	29	95	28	30	4.36
1 4002 63	25-60 kPa	25	G 1¼	76	134	29	95	28	30	5.38
1 4002 64	25-60 kPa	32	G 1½	114	150	47	95	32	32	9.48
1 4002 65	25-60 kPa	40	G 1¾	132	160	55	95	41	41	14.95
1 4002 66	25-60 kPa	50	G 2 ¾	140	160	55	94	41	41	14.95

Differential Pressure Control Valve

4002

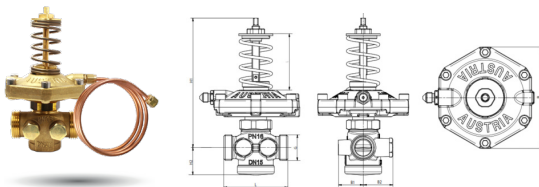

Technical data:

- Body material DZR
- Max operating pressure: 16 bar
- Max operating temperature: 130 °C up to DN32, 110 °C from DN40
- Min operating temperature: -20 °C
- Max differential pressure: 4 bar
- Connection thread: ISO 228-1 flat seal

Connections to be ordered separately see below



Part number	Regulating range	DN	G	L	H1	H2	B	B1	B2	Kvs
1 4002 31	50-150 kPa	15	G ¾	66	133	28	94	26	31	2.6
1 4002 32	50-150 kPa	20	G 1	76	134	29	94	28	33	4.2
1 4002 33	50-150 kPa	25	G 1¼	76	134	29	94	28	33	5.3
1 4002 34	50-150 kPa	32	G 1½	114	150	47	94	32	32	7.1
1 4002 35	50-150 kPa	40	G 1¾	132	160	57	94	41	41	12.4
1 4002 36	50-150 kPa	50	G 2 ¾	140	160	57	94	41	41	16.2

End Connections for DPCV 4002 3x

6220

6236



Steel Conns Part number	Copper Conns Part number	Size	Thread R	Cu size
1 6220 21	1 6236 11	DN15	½	15
1 6220 12	1 6236 22	DN20	¾	22
1 6220 63	1 6236 63	DN25	1	28
1 6220 64	1 6236 64	DN32	1¼	35
1 6220 65	1 6236 65	DN40	1½	42
1 6220 66	1 6236 66	DN50	2	54

Fixed Differential Pressure Control Valve



4002 2x



4002 8x

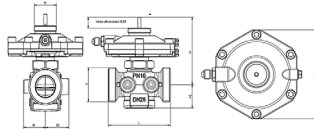
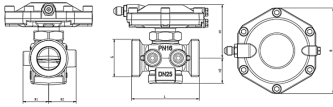

Part number	DN	G	L	H1	H2	B	Kvs
1 4002 21	15	G 3/4	66	59	28	94	2.66
1 4002 22	20	G 1	76	60	29	94	4.36
1 4002 23	25	G 1 1/4	76	60	29	94	5.38
1 4002 24	32	G 1 1/2	114	76	46	94	9.48
1 4002 25	40	G 1 3/4	132	86	55	94	14.95
1 4002 26	50	G 2 1/4	140	86	55	94	14.95
1 4002 81	15	G 3/4	66	81	28	94	2.66
1 4002 82	20	G 1	76	82	29	94	4.36
1 4002 83	25	G 1 1/4	76	82	29	94	5.38
1 4002 84	32	G 1 1/2	114	98	47	94	9.48
1 4002 85	40	G 1 3/4	132	108	55	94	14.95
1 4002 86	50	G 2 1/4	140	108	55	94	14.95

Technical data:

- Body material DZR
 - Max operating pressure: 16 bar
 - Max operating temperature: 130 °C up to DN32, 110 °C from DN40
 - Min operating temperature: -20 °C
 - Max differential pressure: 4 bar
 - Connection thread: ISO 228-1
 - DN15 & 20 Eurocone, DN25-50 flat seal
- Connections and actuators to be ordered separately see below and page 13

End Connections for DPCV 4002 2x/4x/6x/8x

6220

6274

6236



Steel Conns Part number	Copper Conns Part number	Size	Thread R	Cu size
1 6210 21	1 6274 03	DN15	1/2	15
1 6210 02	1 6273 01	DN20	3/4	22
1 6220 63	1 6236 63	DN25	1	28
1 6220 64	1 6236 64	DN32	1 1/4	35
1 6220 65	1 6236 65	DN40	1 1/2	42
1 6220 66	1 6236 66	DN50	2	54

DPCV Partnering Valve

4217 GML STRÖMAX

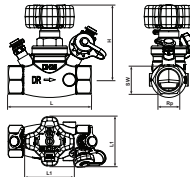

Technical data:

- Body material DZR
- Max operating pressure: 20 bar
- Max operating temperature: 130°C up to DN32, 110°C from DN40
- Connection thread: ISO 228-1

Part number	DN	Rp	L	L1	H	SW	SW hexagon	SW octagon
1 4217 19	15	1/2	100	71	97	27		3.49
1 4217 12	20	3/4	100	71	97	32		6.11
1 4217 13	25	1	120	71	107	41		9.22
1 4217 14	32	1 1/4	140	71	112		50	18.83
1 4217 15	40	1 1/2	150	71	112		55	23.29
1 4217 16	50	2	165	110	136		70	35.26
1 4217 17	65	2 1/2	190	110	141		85	52.11

1. BALANCING VALVES

Flanged Differential Pressure Control Valve

F 4007

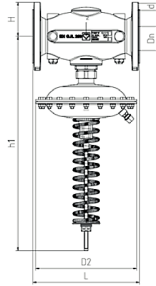

Technical data:

- Body material Cast Iron
- Max operating pressure: 16 bar
- Max operating temperature: 110 °C
- Min operating temperature: -10 °C
- Max differential pressure: 4 bar
- End flange: BS EN 1092-2 PN16



Part number	Regulating range	DN	L [mm]	h1 [mm]	H [mm]	d [mm]	D2 [mm]
F 4007 26	50-150 kPa	50	230	566	82	19	156
F 4007 07	10-40 kPa	65	290	581	93	19	275
F 4007 17	20-80 kPa	65	290	567	93	19	156
F 4007 27	50-150 kPa	65	290	567	93	19	156
F 4007 08	10-40 kPa	80	310	603	113	19	275
F 4007 18	20-80 kPa	80	310	588	113	19	156
F 4007 38	20-80 kPa 80 HF	80	310	603	113	19	275
F 4007 28	50-150 kPa	80	310	588	113	19	156
F 4007 09	10-40 kPa	100	350	603	112	19	275
F 4007 19	20-80 kPa	100	350	603	112	19	275
F 4007 29	50-150 kPa	100	350	588	112	19	156
F 4007 20	20-80 kPa	125	400	727	181	19	275
F 4007 30	50-150 kPa	125	400	727	181	19	275
F 4007 21	20-80 kPa	150	480	721	185	23	275
F 4007 31	50-150 kPa	150	480	721	185	23	275
F 4007 32	50-150 kPa	200	600	808	222	23	275

Flanged DPCV VODRV Partnering Valve

4218 GF

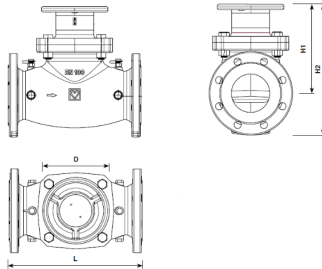

Technical data:

- Body material Cast Iron
- Max operating pressure: 16 bar
- Max operating temperature: 110 °C
- Min operating temperature: -10 °C
- End flange: BS EN 1092-2 PN16

Capillary test point 1 0284 03 to be ordered separately see page 20



Part number	DN	L	H1	H2	D	Kvs
1 4218 81	65	290	186	280	150	67
1 4218 82	80	310	208	308	175	107
1 4218 83	100	350	235	345	175	169
1 4218 84	125	400	260	385	265	256
1 4218 85	150	480	308	451	265	390
1 4218 86	200	600	449	619	450	676

SMART Pressure Independent Control Valve

4006

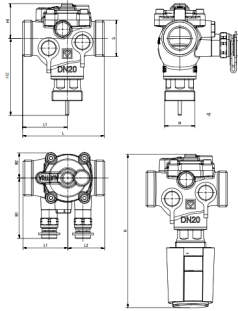

Technical data:

- Body material DZR
- Max operating pressure: 25 bar
- Max operating temperature: 130 °C
- Min operating temperature: -20 °C
- Max differential pressure: 6 bar (LF & MF 4 bar)
- Stroke: 4mm
- Actuator mounting thread: M28 x 1.5
- Connection thread: ISO 228-1 Flat Seal

Connections and actuators to be ordered separately see below and page 11 & 13

Part number	DN	l/h @ 100%	L	H1	H2	H	B1	B2	L1	L2	M
1 4006 30	15 LF	120	75	35	69	159	50	23	41	34	28
1 4006 39	15 MF	190	75	35	69	159	50	23	41	34	28
1 4006 51	15 SF	800	75	32	71	158	55	23	41	34	28
1 4006 71	15 HF	1200	75	32	71	158	55	23	41	34	28
1 4006 52	20 SF	1200	75	32	71	158	56	23	41	34	28
1 4006 72	20 HF	2000	75	32	71	158	56	23	41	34	28

End Connections for SMART PICVs

6220

6236



Steel Conns Part number	Copper Conns Part number	Size	Thread R	Cu size
1 6220 21	1 6236 11	DN15	½	15
1 6220 12	1 6236 22	DN20	¾	22

4006



Part number	List Price
1 4006 02	£8.92

Setting Key

For Differential Pressure Control Valves 4002
For Pressure Independent Control Valves 4006/4406

Motorised Actuator for PICV

HVACT

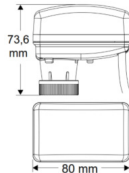

Technical data:

- CE to EMC Directives 2004/108/EC & 2006/95/EC
- 3 point floating control (HVACT24-01 & HVACT230-01)
- Modulating 0-10 V DC signal with proportional stroke recognition (HVACTMOD24-01)
- IP 43 T50
- Direct mounting for M28 x 1.5

Part number	Type	Control	Supply voltage	Mounting thread	Stroke [mm]	Actuating Force
HVACT24-01	3 point	-	24 V	M28 x 1.5	6.3	140 N
HVACT230-01	3 point	-	230 V	M28 x 1.5	6.3	140 N
HVACTMOD24-01	Modulating	0-10 V DC	24 V	M28 x 1.5	6.3	160 N

1. BALANCING VALVES

Pressure Independent Control Valve

4006

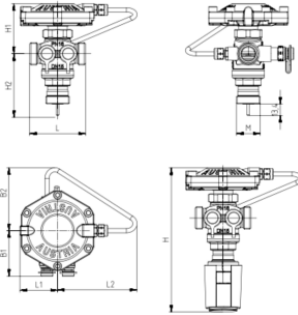

Technical data:

- Body material DZR
- Max operating pressure: 25 bar
- Max operating temperature: 130 °C up to DN32, 110 °C from DN40
- Min operating temperature: -20 °C
- Max differential pressure: 4 bar
- Stroke: 4mm
- Actuator mounting thread: M28 x 1.5
- Connection thread: ISO 228-1

Connections and actuators to be ordered separately see below and pages 11 & 13

Limited stock - available while stocks last



Part number	DN	l/h @ 100%	L	H1	H2	H	B1	B2	L1	L2	M
1 4006 11	15	430	66	59	75	189	54	74	45	94	28
1 4006 12	20	900	76	60	75	190	56	72	45	89	28
1 4006 13	25	1900	76	60	75	190	56	72	45	89	28
1 4006 14	32	2500	114	76	86	217	47	76	57	86	28
1 4006 15	40	5200	132	86	97	238	47	82	66	85	28
1 4006 16	50	4820	140	86	97	238	47	82	70	85	28

End Connections for PICV 4006

6220

6236



Steel Conns Part number	Copper Conns Part number	Size	Thread R	Cu size
1 6210 21	1 6274 03	DN15	½	15
1 6210 02	1 6273 01	DN20	¾	22
1 6220 63	1 6236 63	DN25	1	28
1 6220 64	1 6236 64	DN32	1¼	35
1 6220 65	1 6236 65	DN40	1½	42
1 6220 66	1 6236 66	DN50	2	54

Pressure Independent Control Valve

4406

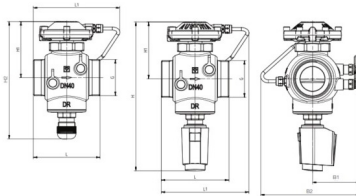

Technical data:

- Body material DZR
- Max operating pressure: 25 bar
- Max operating temperature: 130 °C up to DN32, 110 °C from DN40
- Min operating temperature: -20 °C
- Max differential pressure: 6 bar
- Stroke: 6mm
- Actuator mounting thread: M28 x 1.5
- Connection thread: ISO 228-1 Flat Seal

Connections and actuators to be ordered separately see pages 11 & 13



Part number	DN	l/h @ 100%	Min DP	L	H1	H2	H	B1	B2	L1
1 4406 23	25	3500	35	75	80	174	222	61	138	45
1 4406 24	32	6000	35	100	98	198	246	69	151	57
1 4406 25	40	7500	30	110	97	198	246	68	154	66
1 4406 26	50	12000	40	130	102	203	251	77	162	70

Thermo-electric Actuator

7708



Technical data:

- CE to EN 60730
- 2 Point or pulse control (with Limit switches 1 7708 87)
- IP 54/II
- Red adapter ring supplied for M28 x 1.5 (Apart from 1 7708 27 & 1 7708 48)



Part number	Type	Supply voltage	Mounting thread	Max stroke [mm]	Adapter	Cable	End switch	Actuating force	Power consumption
1 7708 52	NC	24 V	M28 x 1.5	5	M28 x 1.5 (red)	fix	no	100 N	1 W
1 7708 53	NC	230 V	M28 x 1.5	5	M28 x 1.5 (red)	fix	no	100 N	1 W
1 7708 24	NO	230 V	M28 x 1.5	5	M28 x 1.5 (red)	fix	no	100 N	1 W
1 7708 87	NC	230 V	M28 x 1.5	5	M28 x 1.5 (red)	fix	yes	100 N	1 W
1 7708 48	NC	24 V	M28 x 1.5	6.5	M28 x 1.5 (blue)	fix	no	125 N	1.2 W
1 7708 27	NC	230 V	M28 x 1.5	6.5	M28 x 1.5 (blue)	fix	no	125 N	1.2 W

7990



Technical data:

- CE to EN 60730
- Modulating 0-10 V DC signal
- Proportional stroke recognition (1779032)
- IP 54/III
- Blue adapter ring supplied for M28 x 1.5



Part number	Type	Control	Supply voltage	Mounting thread	Max stroke [mm]	Adapter	Actuating force
1 7990 31	NC	0-10 V DC	24V	M28 x 1.5	5	M28 x 1.5 (blue)	100 N
1 7990 32	NC	0-10 V DC	24V	M28 x 1.5	6.5	M28 x 1.5 (blue)	125 N

Actuator Adapter Rings

7708-80

7708-98



Part number	Suitability
1 7708 80	to suit 7217-TS-98/99 only
1 7708 98	To suit M30 x 1.5 mounting threads only

End Connections for PICV 4406

6220

6236



Steel Conns Part number	Copper Conns Part number	Size	Thread R	Cu size
1 6220 63	1 6236 63	DN25	1	28
1 6220 94	1 6236 65	DN32	1¼	42
1 6220 95	1 6236 74	DN40	1½	35
1 6220 96	-	DN50	2	-

1. BALANCING VALVES

Flanged Pressure Independent Control Valve

F4006

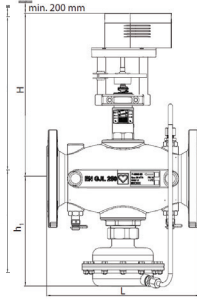

Technical data:

- Body material Cast Iron
- Max operating pressure: 16 bar
- Max operating temperature: 110 °C
- Min operating temperature: -20 °C
- Max Differential Pressure: 4 bar
- End flange: BS EN 1092-2 PN16

Actuators to be ordered separately see page 15

Part number	DN	Stroke [mm]	l/hr	Min DP	Kvs	H	h1	L
F 4006 62	50	15	3,750 - 15,000	40	23.7	310	210	230
F 4006 63	65	15	5,000 - 20,000	40	31.6	310	210	290
F 4006 64	80	20	9,000 - 36,000	40	56.9	395	230	310
F 4006 65	100	20	10,750 - 43,000	40	68.0	395	232	350
F 4006 66	125	40	25,000 - 100,000	40	158.1	590	410	400
F 4006 56	125 HF	40	37,500 - 150,000	70	179.3	590	410	400
F 4006 67	150	40	36,250 - 145,000	40	229.3	595	425	480
F 4006 57	150 HF	40	50,000 - 200,000	70	239.0	595	425	480
F 4006 68	200	40	52,500 - 210,000	40	332.0	630	585	600
F 4006 58	200 HF	40	75,000 - 300,000	70	358.6	630	585	600
F 4006 48	200 UHF	40	87,500 - 350,000	85	379.6	630	585	600
F 4006 69	250 SF	40	87,500 - 350,000	50	495.0	665	620	730
F 4006 59	250 HF	40	102,500 - 410,000	70	490.0	665	620	730

F4006 Actuator Selection

DN	230V 2/3 point			24V 2/3 point			24V Modulating 10V DC		
	F 7712 81	F 7712 82	F 7712 84	F 7712 95	F 7712 96	F 7712 98	F 7712 90	F 7712 91	F 7712 92
50	●	-	-	●	-	-	●	-	-
65	●	-	-	●	-	-	●	-	-
80	-	●	-	-	●	-	-	●	-
100	-	●	-	-	●	-	-	●	-
125	-	-	●	-	-	●	-	-	●
150	-	-	●	-	-	●	-	-	●
200	-	-	●	-	-	●	-	-	●
250	-	-	●	-	-	●	-	-	●

Pressure Independent 6 Port Control Valve

2460



Part number	DN
1 2460 01	15
1 2460 02	20

NEW!

**Coming later in 2024
Pressure Independent
6 Port Control Valve**

Motorised Actuator for Flanged Control Valves

F7712

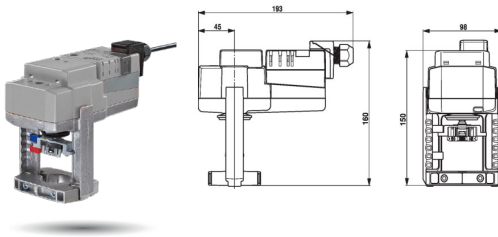

Technical data:

- CE to 2014/30/EG
- IEC/EN 60730-1 and IEC/EN 60730-2-14
- IP 54, NEMA 2
- 500N Actuating force
- Direct mounting



Part number	Type	Control	Supply voltage	Running time	Stroke [mm]	Actuating Force
F 7712 95	2/3 point	-	24 V	150s/15mm	15	500 N
F 7712 81	2/3 point	-	230 V	150s/15mm	15	500 N
F 7712 90	Modulating	0-10 V DC	24 V	150s/15mm	15	500 N

F7712

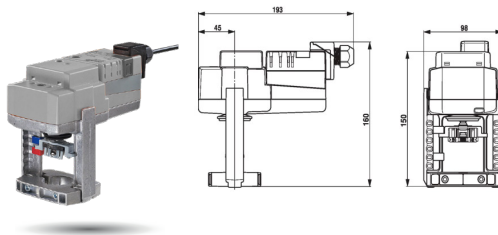

Technical data:

- CE to 2014/30/EG
- IEC/EN 60730-1 and IEC/EN 60730-2-14
- IP 54, NEMA 2
- 1000N Actuating force
- Direct mounting



Part number	Type	Control	Supply voltage	Running time	Stroke [mm]	Actuating Force
F 7712 96	2/3 point	-	24 V	150s/20mm	20	1000 N
F 7712 82	2/3 point	-	230 V	150s/20mm	20	1000 N
F 7712 91	Modulating	0-10 V DC	24 V	150s/20mm	20	1000 N

F7712

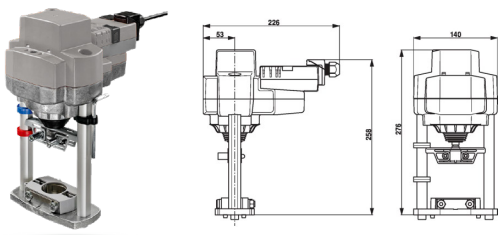

Technical data:

- CE to 2014/30/EG
- IEC/EN 60730-1 and IEC/EN 60730-2-14
- IP 54, NEMA 2
- 2500N Actuating force
- Direct mounting



Part number	Type	Control	Supply voltage	Running time	Stroke [mm]	Actuating Force
F 7712 98	2/3 point	-	24 V	150s/40mm	40	2500 N
F 7712 84	2/3 point	-	230 V	150s/40mm	40	2500 N
F 7712 92	Modulating	0-10 V DC	24 V	150s/40mm	40	2500 N

1. BALANCING VALVES

Connect 4 CS

4500 0x

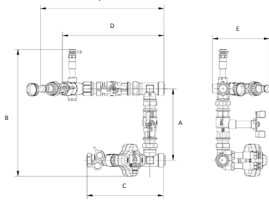
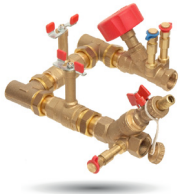

Connect 4 for terminal units with Commissioning Valve



Technical data:

- Min. operating temperature: - 20 °C
- Max. operating temperature: up to 130 °C
- Pressure rating: PN 16

Part number	DN	A	B	C	D	E	F	kv max	kvs orifice
1 4500 11	15 LF	158	275	166	215	124	259	0.43	0.48
1 4500 21	15 MF	158	275	166	215	124	259	0.75	0.97
1 4500 01	15	158	275	166	215	124	259	1.39	1.95
1 4500 02	20	166	283	175	232	126	281	2.19	3.95
1 4500 03	25	209	332	185	290	136	332	5.06	7.9

Connect 4 PICV

4500 4x

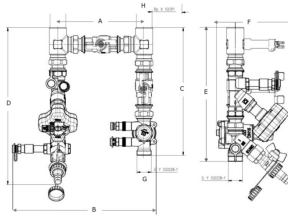

Connect 4 for terminal units with Pressure Independent Control Valve



Technical data:

- Min. operating temperature: - 20 °C
- Max. operating temperature: up to 100 °C
- Pressure rating: PN 16

Connections and actuators to be ordered separately see below and page 11 & 15

Part number	DN	A	B	C	D	E	F	G (G)	H (RP)	kvs orifice
1 4500 40	15 ULF	158	265	235	306	264	137	G ¾	½	0.19
1 4500 49	15 LF	158	265	235	289	246	137	G ¾	½	0.51
1 4500 41	15 MF	158	265	235	289	246	137	G ¾	½	1.01
1 4500 44	15	158	265	235	289	246	137	G ¾	½	1.89
1 4500 42	20	170	277	244	335	289	132	G 1	¾	4.63
1 4500 39	20 HF	170	277	244	335	289	132	G 1	¾	4.63
1 4500 43	25	209	374	270	340	304	172	G 1¼	1	8.52

End Connections for Connect 4 PICV

6220

6274

6236



Steel Conns Part number	Copper Conns Part number	Size	Thread R	Cu size
1 6210 21	1 6274 03	DN15	½	15
1 6210 02	1 6273 01	DN20	¾	22
1 6220 63	1 6236 63	DN25	1	28

Connect 4 RP

4500 6x

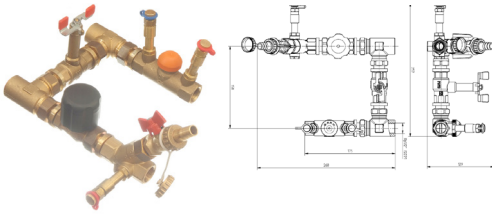

Connect 4 for radiant panels with Thermostatic Control Valve

Technical data:

- Min. operating temperature: - 10 °C
- Max. operating temperature: up to 120 °C
- Pressure rating: PN 16

Actuators or remote adjusters to be ordered separately see page 13

Part number	DN	Insert	Preset 1 kvs	Preset 2 kvs	Preset 3 kvs	Preset 4 kvs	Preset 5 kvs	Preset 6 kvs
1 4500 66	15	TS-99-FV	0.019	0.042	0.091	0.158	0.266	0.291
1 4500 67	15	TS-98-V	0.14	0.3	0.42	0.5	0.53	0.56

Actuator adapter for Connect 4 RP

7708



Order number	List Price
1 7708 80	£8.89

Adapter for HERZ Actuator, grey for use with thermostatic valves 7217

Thermostatic Remote Adjuster

9330



Part number	Mounting thread	Temperature range	Capillary length
1 9330 05	M28 x 1.5	6 - 28 °C	2m
1 9330 10	M28 x 1.5	6 - 28 °C	5m
1 9330 18	M28 x 1.5	6 - 28 °C	8m
1 9330 20	M28 x 1.5	6 - 28 °C	10m

Hose Union for Strainer Drain Valve

6206



Part number
1 6206 01

1. BALANCING VALVES

Compact Connect 4 H

4600

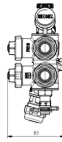
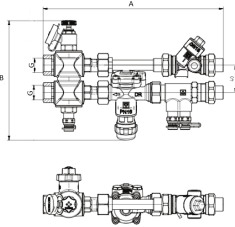

Connect 4 for direct mounting to terminal unit 40mm centre copper tails with Pressure Independent Control Valve

Fan coil tails in horizontal orientation

Technical data:

- Min. operating temperature: - 20 °C
- Max. operating temperature: up to 130 °C

FCU connections & Actuators to be ordered separately see page 11



Part number Flow on right (RH)	Part number Flow on left (LH)	FCU 15mm Cu connections	FCU 22mm Cu connections	DN	A	B	G (Rp)	kvs orifice
1 4600 38	1 4700 08	1 6236 11	-	15 ULF	264	174	½	0.19
1 4600 30	1 4700 00	1 6236 11	-	15 LF	264	174	½	0.52
1 4600 39	1 4700 09	1 6236 11	-	15 MF	264	174	½	1.06
1 4600 31	1 4700 01	1 6236 11	-	15	264	174	½	1.62
1 4600 36	1 4700 06	1 6236 02	1 6236 22	20	267	180	¾	3.39
1 4600 37	1 4700 07	1 6236 02	1 6236 22	20 HF	267	180	¾	None

Compact Connect 4 V

4700

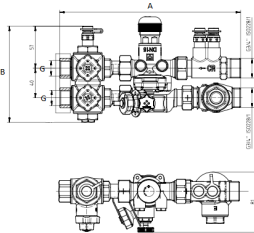

Connect 4 for direct mounting to terminal unit 40mm centre copper tails with Pressure Independent Control Valve

Fan coil tails in vertical orientation

Technical data:

- Min. operating temperature: - 20 °C
- Max. operating temperature: up to 130 °C

FCU connections & Actuators to be ordered separately see page 11



Part number Flow on right (RH)	Part number Flow on left (LH)	FCU 15mm Cu connections	FCU 22mm Cu connections	DN	A	B	G (Rp)	kvs orifice
1 4700 28	1 4700 38	1 6236 11	-	15 ULF	265	158	½	0.19
1 4700 20	1 4700 30	1 6236 11	-	15 LF	265	158	½	0.52
1 4700 79	1 4700 89	1 6236 11	-	15 MF	265	158	½	1.06
1 4700 71	1 4700 81	1 6236 11	-	15	265	158	½	1.62
1 4700 26	1 4700 36	1 6236 02	1 6236 22	20	269	154	¾	3.39
1 4700 27	1 4700 37	1 6236 02	1 6236 22	20 HF	269	154	¾"	None

Flat Faced Soldered FCU Connections

6236



Technical data:

- Material: Nickel plated brass
- Max operating pressure: 10 bar
- Max operating temperature: 110 °C

Part number	Size	Cu size	SW
1 6236 11	DN15	15	30
1 6236 02	DN20	15	36
1 6236 22	DN20	22	36

HerzCON

4600



Pressure Independent Connect 4 with insulation

Technical data:

- Max. operating pressure: 25 bar
- Min. operating temperature: - 20 °C
- Max. operating temperature: 130 °C
- Lift: 4 mm

Insulation box (fire behaviour):

Method	Class
DIN EN ISO 11925-2	E
DIN 4102-1	B2
FMVSS 302	Fulfilled
UL 94	HBF

Connections and actuators to be ordered separately
see pages 75 and 11 respectively



Part number inc insulation	DN	Flow rate (l/h)
1 4600 50	15LF	20 - 100
1 4600 59	15MF	40 - 200
1 4600 76	15SF	160 - 800
1 4600 56	15HF	240 - 1200
1 4600 77	20SF	240 - 1200
1 4600 57	20HF	400 - 2000
1 4600 58	25	100 - 1900

DN15 - DN20

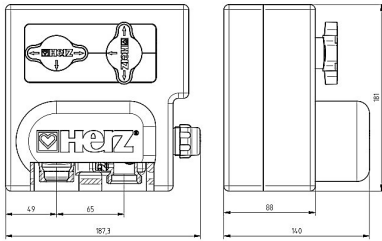

DN25

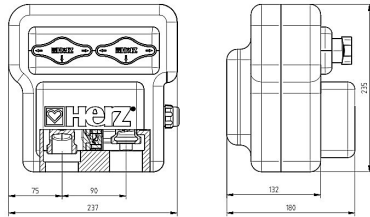

DN 15

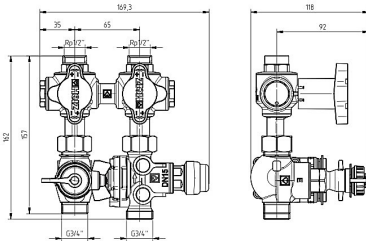

DN 20SF, HF

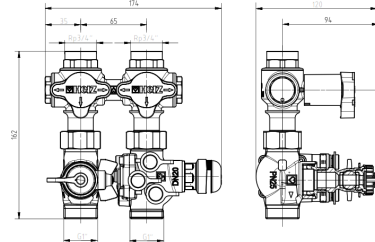

DN 15SF, HF

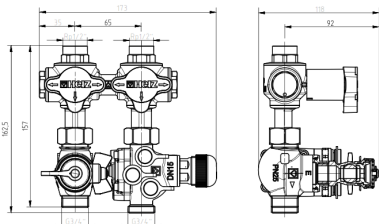

DN 25

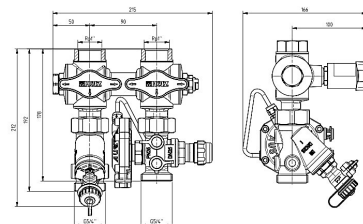

1. BALANCING VALVES

Test Points

0284



Test points for HERZ-STRÖMAX-Circuit regulating valves (manufactured from 2004), brass version, blue cap (return) for flow computer.

Part number	Size
1 0284 01	¼



Test points for HERZ-STRÖMAX-Circuit regulating valves (manufactured from 2004), brass version, red cap (flow) for flow computer.

Part number	Size
1 0284 02	¼



Test points for HERZ-STRÖMAX-Circuit regulating valves Brass version, blue cap (return) for flow computer. Extended model for insulated valves.

Part number	Size
1 0284 11	¼



Test points for HERZ-STRÖMAX-Circuit regulating valves. Brass version, red cap (flow) for flow computer. Extended model for insulated valves.

Part number	Size
1 0284 12	¼



Test points with draining function Brass version, blue cap, with swivel hose connection. Test point for flow computer.

Part number	Size
1 0284 21	¼



Test points with draining function Brass version, red cap, with swivel hose connection. Test point for flow computer.

Part number	Size
1 0284 22	¼



Test points with capillary connection brass version, blue cap (return).

Part number
1 0284 03



Test points with capillary connection brass version, red cap (flow).

Part number	Size
1 0284 04	¼

Digital Manometer

8900



Part number	Description	IP
1890005	Digital Manometer	65

Technical data:

- Max operating pressure: 12 bar
- Measuring range: 0 – 10 bar
- Bluetooth connection
- IOS & Android compatible

Thermo-Pressure Gauge

2670

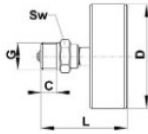

Technical data:

- Combined temperature & pressure gauge
- Pressure range up to 4 bar
- Temperature range up to 120 °C

Part number	G	C	D	L	SW
1 2670 01	½	12	80	66.5	22

Accessories for Differential Pressure Controllers 4002

4002, 4007



Ball valve with nipple

Part number	Size
1 4007 78	⅜

Capillary for Differential Pressure Controller with ball valve 1/8

Part number	Length
1 4002 78	1.0 m

4002, 4007



Capillary for Differential Pressure Controller with screw plug G 1/4 and nipples 1/8 G x 1/4 G

Part number	Length
1 4007 79	1.0 m
1 4007 80	1.5 m
1 4002 80	2.0 m

4002



Replacement Spring for 4002 Differential Pressure Controller

Part number	DP Range
1 4002 97	5 - 30 kPa
1 4002 98	25 - 60 kPa
1 4002 99	45 - 80 kPa

2. GENERAL VALVES

Ball Valve

2190 0X

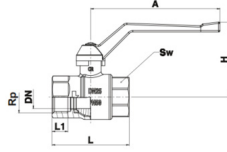

Technical data:

- UK Water Reg 4 Compliant
- Body material DZR
- Max operating pressure: As per data table
- Max operating temperature: 150 °C
- Min operating temperature: -30 °C
- Connection thread: ISO 228-1



Part number	DN	PN	Rp	L	L1	H	A	Sw	kv
1 2190 01	15	50	½	59	13	53	90	25	17
1 2190 02	20	50	¾	65	14	56	90	32	34
1 2190 03	25	50	1	80.5	16.5	77	135	41	55
1 2190 04	32	40	1¼	91	17	81	135	48	102
1 2190 05	40	40	1½	104	19.5	95	180	55	165
1 2190 06	50	40	2	125.5	22.5	101	180	70	270

Tee handle for 2190 0x

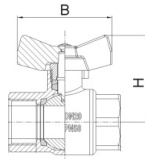

Part number	To suit	DN	B	H
1 6386 70	DN15 & 20	15	55	47
1 6386 70	DN15 & 20	20	55	53
1 6386 71	DN25 & 32	25	75	57
1 6386 71	DN25 & 32	32	75	60

Ball Valve with extended stem

2190 2X

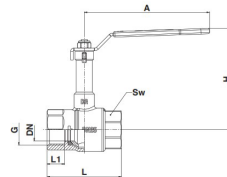

Technical data:

- UK Water Reg 4 Compliant
- Body material DZR
- Max operating pressure 25 bar
- Max operating temperature: 130 °C
- Min operating temperature: -10 °C
- Connection thread: ISO 228-1



Part number	DN	PN	G	L	H	A	Sw	kv
1 2190 21	15	25	½	59	90	90	25	17
1 2190 22	20	25	¾	65	93	90	32	34
1 2190 23	25	25	1	80.5	107	135	41	55
1 2190 24	32	25	1¼	91	111	135	48	102
1 2190 25	40	25	1½	100	136	180	55	165
1 2190 26	50	25	2	118	144	180	69	270

Compression Ball Valve Red Lever

2190 4X

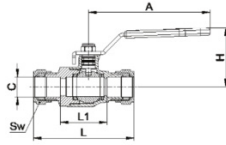

Technical data:

- UK Water Reg 4 Compliant
- Body material DZR
- Max operating pressure: 16 bar
- Max operating temperature: 120 °C
- Compression ends to BS EN 1254-2



Part number	DN	Cu	C	L	L1	H	A	Sw	kv
1 2190 41	15	15	15.2	76.5	35.5	47	90	24	17
1 2190 42	20	22	22.2	81	37	49	90	32	34
1 2190 43	25	28	28.1	95	44.4	61	135	37	55
1 2190 44	32	35	35.1	108.5	54.6	65	135	46	102
1 2190 45	40	42	42.2	122	60	84	180	60	165
1 2190 46	50	54	54.4	134	72	90	180	70	270

Compression Ball Valve Blue Lever

2190 5X

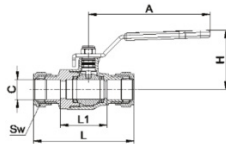

Technical data:

- UK Water Reg 4 Compliant
- Body material DZR
- Max operating pressure: 16 bar
- Max operating temperature: 120 °C
- Compression ends to BS EN 1254-2



Part number	DN	Cu	C	L	L1	H	A	Sw	kv
1 2190 51	15	15	15.2	76.5	35.5	47	90	24	17
1 2190 52	20	22	22.2	81	37	49	90	32	34
1 2190 53	25	28	28.1	95	44.4	61	135	37	55
1 2190 54	32	35	35.1	108.5	54.6	65	135	46	102
1 2190 55	40	42	42.2	122	60	84	180	60	165
1 2190 56	50	54	54.4	134	72	90	180	70	270

Compression Ball Valve with extended stem

2190 6X

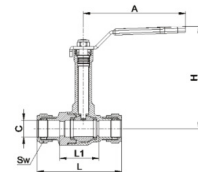

Technical data:

- UK Water Reg 4 Compliant
- Body material DZR
- Max operating pressure: 16 bar
- Max operating temperature: 120 °C
- Compression ends to BS EN 1254-2



Part number	DN	Cu	C	L	L1	H	A	Sw	kv
1 2190 61	15	15	15.2	76.5	35.5	94	90	24	17
1 2190 62	20	22	22.2	81	37	97	90	32	34
1 2190 63	25	28	28.1	95	44.4	110	135	37	55
1 2190 64	32	35	35.1	108.5	54.6	114	135	46	102
1 2190 65	40	42	42.2	122	60	135	180	60	165
1 2190 66	50	54	54.4	134	72	142	180	70	270

2. GENERAL VALVES

Ball Valve with Tee handle

2206 Red Tee



2206 Blue Tee

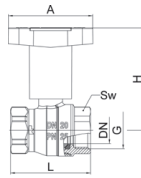

Technical data:

- UK Water Reg 4 Compliant
- Body material DZR
- Max operating pressure: 25 bar
- Max operating temperature: 150 °C
- Min operating temperature: -30 °C
- Connection thread: ISO 228-1



Part number Red handle	Part number Blue handle	DN	PN	G	L	H	A	Sw
1 2206 41	1 2206 51	15	25	½	51	70	60	25
1 2206 42	1 2206 52	20	25	¾	57	73	60	31
1 2206 43	1 2206 53	25	25	1	73	82	85	39
1 2206 44	1 2206 54	32	25	1¼	84	88	85	48
1 2206 45	1 2206 55	40	25	1½	95	120	120	55
1 2206 46	1 2206 56	50	25	2	112	126	120	70

Ball Valve with Tee handle and temperature gauge

2206 Red Tee



2206 Blue Tee

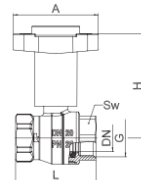

Technical data:

- UK Water Reg 4 Compliant
- Body material DZR
- Max operating pressure: 25 bar
- Max operating temperature: 150 °C
- Min operating temperature: -30 °C
- Connection thread: ISO 228-1



Part number Red handle	Part number Blue handle	DN	PN	G	L	H	A	Sw
1 2206 61	1 2206 71	15	25	½	51	70	60	25
1 2206 62	1 2206 72	20	25	¾	57	73	60	31
1 2206 63	1 2206 73	25	25	1	73	82	85	39
1 2206 64	1 2206 74	32	25	1¼	84	88	85	48
1 2206 65	1 2206 75	40	25	1½	95	120	120	55
1 2206 66	1 2206 76	50	25	2	112	126	120	70

Lockshield Ball Valve

2190LS

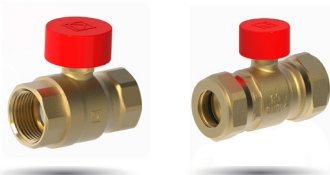

Technical data:

- UK Water Reg 4 Compliant
- Body material DZR
- Max operating pressure: 25 bar (screwed) 16 bar (compression)
- Max operating temperature: 150 °C
- Min operating temperature: -30 °C
- Connection thread: ISO 228-1
- Compression ends to BS EN 1254-2



Part number Screwed	Part number Compression	DN	G	L	H	A	Sw
1 2190 01LS	1 2190 41LS	15	½	51	70	60	25
1 2190 02LS	1 2190 42LS	20	¾	57	73	60	31
1 2190 03LS	1 2190 43LS	25	1	73	82	85	39
1 2190 04LS	1 2190 44LS	32	1¼	84	88	85	48
1 2190 05LS	1 2190 45LS	40	1½	95	120	120	55
1 2190 06LS	1 2190 46LS	50	2	112	126	120	70

Gate Valve with non-rising spindle

HV5516

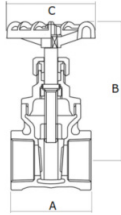

Technical data:

- BS EN 12288:2010
- Body material Bronze
- Max operating pressure: 16 bar
- Max operating temperature: 170 °C
- Min operating temperature: -10 °C
- Connection thread: ISO 7-1 Rc



Limited stock - available while stocks last

Part number	DN	Rc	A	B	C
HV5516-01	15	½	47	76	54
HV5516-02	20	¾	51	84	58
HV5516-03	25	1	54	95	64
HV5516-04	32	1¼	59	116	70
HV5516-05	40	1½	64	127	74
HV5516-06	50	2	71	151	85

Gate Valve with non-rising spindle

HV5520

HV5520LS

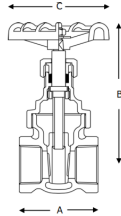

Technical data:

- UK Water Reg 4 Compliant
- BS EN 12288:2010
- Body material Bronze
- Max operating pressure: 20 bar
- Max operating temperature: 180 °C
- Min operating temperature: -10 °C
- Connection thread: ISO 7-1 Rc



Limited stock - available while stocks last

Part number Handwheel	Part number Lockshield	DN	Rc	A	B	C
HV5520-01	HV5520LS-01	15	½	48	78	53
HV5520-02	HV5520LS-02	20	¾	52	94	64
HV5520-03	HV5520LS-03	25	1	59	109	69
HV5520-04	HV5520LS-04	32	1¼	63	120	80
HV5520-05	HV5520LS-05	40	1½	67	142	89
HV5520-06	HV5520LS-06	50	2	74	163	102

2. GENERAL VALVES

Gate Valve with non-rising spindle

4112

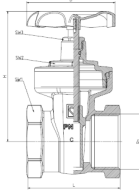

Technical data:

- Body material DZR
- Max operating pressure: 20 bar
- Max operating temperature: 120 °C
- O ring sealings FKM
- Connection thread: ISO 7-1 Rp

Also suitable for fuel oil



Part number	DN	Rp	SW1	SW2	SW3	D	H	L
1 4112 31	15	½	27	21	15	60	84	49.4
1 4112 32	20	¾	32	21	15	60	89	52.4
1 4112 33	25	1	39	26	15	70	408	61
1 4112 34	32	1¼	49	37	15	70	128	69.6
1 4112 35	40	1½	55	41	21	88	145	74
1 4112 36	50	2	68	41	25	88	476	89

Gate Valve with non-rising spindle

4113

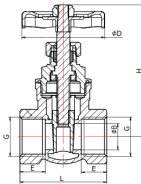

Technical data:

- UK Water Reg 4 Compliance pending
- Body material Bronze
- Max operating pressure: 20 bar
- Max operating temperature: 120 °C
- Connection thread: ISO 7-1 Rp



Part number	DN	G	L	E	H	D	B	SW
3 4113 01	15	½	46	13.5	74	52.5	14	26.5
3 4113 02	20	¾	51.5	13.5	78	59	19	32
3 4113 03	25	1	56	16.5	94	65	24	26.5
3 4113 04	32	1¼	61	18.5	106	72.5	31	47
3 4113 05	40	1½	61.8	18.2	120	85.5	37	53
3 4113 06	50	2	71.5	19.5	139	90	48	66

Compression Gate Valve

HV5154CXC

HV5154CXCLS

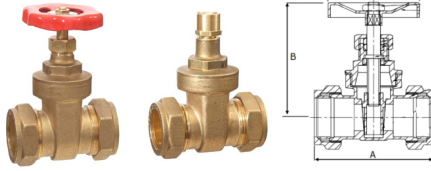

Technical data:

- 15 - 28mm Handwheel only UK Water Reg 4 Compliant
- BS EN 12288:2010
- Body material Brass
- Max operating pressure: 16 bar
- Max operating temperature: 120 °C
- Min operating temperature: -10 °C
- Compression ends to BS EN 1254-2



Limited stock - available while stocks last

Part number Handwheel	Partnumber Lockshield	DN	Cu	A	B	C
HV5154CXC-01	HV5154CXCLS-01	15	15	61.6	65	50.3
HV5154CXC-02	HV5154CXCLS-02	20	22	68.2	75.5	50.3
HV5154CXC-03	HV5154CXCLS-03	25	28	75.5	85.4	59
HV5154CXC-04	-	32	35	91.8	128.3	78.1
HV5154CXC-05	-	40	42	98.7	146.6	98.5
HV5154CXC-06	-	50	54	117	169.7	98.5

Lockshield key for HV5154CXCLS-0x



Part number	List Price
HVLSKEY-01	£17.56

Flanged Gate Valve

HV5150

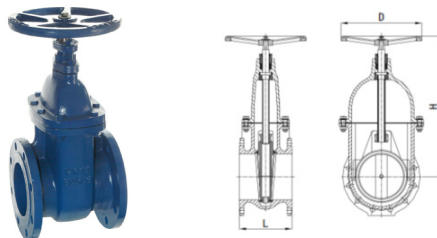

Technical data:

- BS EN 1171
- Body material Ductile Iron
- Max operating pressure: 16 bar
- Max operating temperature: 120 °C
- Min operating temperature: -10 °C
- Flanged to BS EN 1092-2 PN16

Limited stock - available while stocks last

Part number	DN	L	D	H
HV5150-07	65	190	175	300
HV5150-08	80	203	255	355
HV5150-09	100	229	255	390
HV5150-10	125	254	305	461
HV5150-11	150	267	305	513
HV5150-12	200	292	355	616
HV5150-13	250	330	405	705
HV5150-14	300	356	405	800

2. GENERAL VALVES

Fully-lugged Lever Butterfly Valve

4219

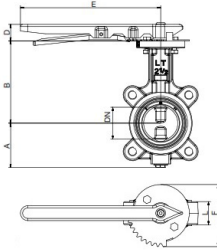

Technical data:

- UK Water Reg 4 Compliance pending
- Body material Cast Iron to EN1563
- Max operating pressure: 16 bar
- Max operating temperature: 110 °C
- Min operating temperature: -20 °C
- End flange: BS EN 1092-2 PN16



Part number	DN	A	B	L	D	E	F	Torque [Nm]
1 4219 11	50	68	125	43	30	255	112	20
1 4219 12	65	80	150	46	30	255	112	20
1 4219 13	80	87	157	50	30	255	112	25
1 4219 14	100	102	182	52	30	255	112	50
1 4219 15	125	120	201	61	30	255	112	50
1 4219 16	150	132	214	61	30	255	112	90

Fully-lugged Gear Butterfly Valve

4219

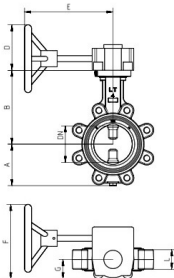

Technical data:

- UK Water Reg 4 Compliance pending
- Body material Cast Iron to EN1563
- Max operating pressure: 16 bar
- Max operating temperature: 110 °C
- Min operating temperature: -20 °C
- End flange: BS EN 1092-2 PN16



Part number	DN	A	B	L	D	E	F	Torque [Nm]
1 4219 72	65	80	150	46	63	217	183	20
1 4219 73	80	87	157	46	63	217	183	25
1 4219 74	100	102	182	52	63	217	183	50
1 4219 75	125	120	201	56	63	217	183	50
1 4219 76	150	132	214	56	63	217	183	90
1 4219 77	200	167	245	60	63	217	183	150
1 4219 78	250	207	283	68	63	217	226	250
1 4219 79	300	222	308	78	63	217	226	350

Fully-lugged Lever Butterfly Valve

HV-BF-FLL

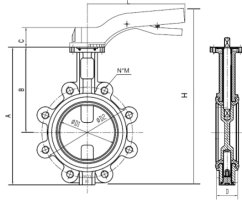

Technical data:

- UK Water Reg 4 Compliant
- EN 593
- Body material Cast Iron
- Max operating pressure: 16 bar
- Max operating temperature: 120 °C
- Min operating temperature: -10 °C
- End flange: BS EN 1092-2 PN16

Limited stock - available while stocks last



Part number	DN	A	B	C	D	L	H	ØD1	ØD2	N*M
HV-BF-FLL-06	50	189	126	35	43	200	255	51.2	125	4 x M16
HV-BF-FLL-07	65	202	133	35	46	200	268	65.6	145	4 x M16
HV-BF-FLL-08	80	238	152	35	46	200	308	80	160	8 x M16
HV-BF-FLL-09	100	276	170	45	52	280	355	102.2	180	8 x M16
HV-BF-FLL-10	125	296	181	45	56	280	388	125.6	210	8 x M16
HV-BF-FLL-11	150	324	196	45	56	280	412	150.6	240	8 x M20

Fully-lugged Gear Butterfly Valve

HV-BF-FLG

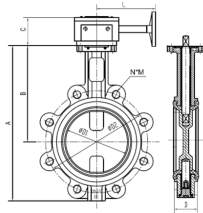

Technical data:

- UK Water Reg 4 Compliant
- EN 593
- Body material Cast Iron
- Max operating pressure: 16 bar
- Max operating temperature: 120 °C
- Min operating temperature: -10 °C
- End flange: BS EN 1092-2 PN16

Limited stock - available while stocks last



Part number	DN	A	B	C	D	L	ØD1	ØD2	N*M
HV-BF-FLG-07	65	202	133	72	46	112	65.6	145	4 x M16
HV-BF-FLG-08	80	238	152	72	46	112	80	160	8 x M16
HV-BF-FLG-09	100	276	170	72	52	112	102.2	180	8 x M16
HV-BF-FLG-10	125	296	181	72	56	112	125.6	210	8 x M16
HV-BF-FLG-11	150	324	196	72	56	112	150.6	240	8 x M20
HV-BF-FLG-12	200	398	238	84	60	171	200.4	295	12 x M20
HV-BF-FLG-13	250	448	258	84	68	171	249	355	12 x M24
HV-BF-FLG-14	300	535	300	85	78	224	295	410	12 x M24

2. GENERAL VALVES

Strainer

2662

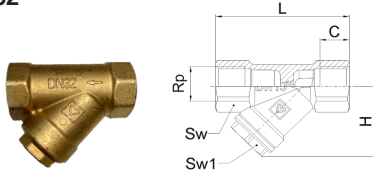

Technical data:

- UK Water Reg 4 Compliant (1 2662 1x)
- Body material Brass / DZR
- Max operating pressure: 25 bar
- Max operating temperature: 130 °C
- Min operating temperature: -30 °C
- Connection thread: ISO 228-1
- Mesh size 0.5mm



Part number Brass	Part number DZR	DN	Rp	C	L	H	SW	SW1	Kvs
1 2662 01	1 2662 11	15	1/2	15	68	37	25	22	2.55
1 2662 02	1 2662 12	20	3/4	16.3	80	46	32	24	5.60
1 2662 03	1 2662 13	25	1	19	90	54	41	25	8.20
-	1 2662 14	32	1 1/4	14	93	62	47	32	16.5
-	1 2662 15	40	1 1/2	16	105	69	54	36	27.4
-	1 2662 16	50	2	18	125	83	67	46	36.7

Strainer

4111

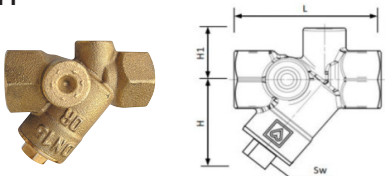

Technical data:

- Body material DZR
- Max operating pressure: 16 bar
- Max operating temperature: 110 °C
- Min operating temperature: -10 °C
- Connection thread: ISO 228-1
- Mesh size 0.75mm



Part number	DN	G	L	H	H1	SW	Kvs
1 4111 17	65	2 1/2	180	118	53	32	64.3
1 4111 18	80	3	220	137	61	32	148.6

Flanged Strainer

4111

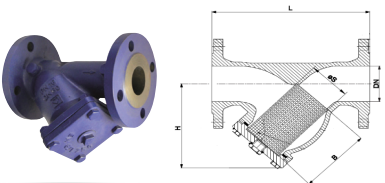

Technical data:

- Body material Cast Iron
- Max operating pressure: 16 bar
- Max operating temperature: 120 °C
- Min operating temperature: -10 °C
- Flanged to BS EN 1092-2 PN16



Part number	DN	Dim.	Mesh	B	H	L	S	Kvs
4 4111 81	65	2 1/2	2.0	132	165	290	78	70
4 4111 82	80	3	2.0	149	175	310	90	114
4 4111 83	100	4	2.0	192	236	350	109	197
4 4111 84	125	5	2.0	227	267	400	135	271
4 4111 85	150	6	2.0	244	298	480	160	349
4 4111 86	200	8	4.0	313	340	600	210	449
4 4111 87	250	10	4.0	395	390	730	258	994
4 4111 88	300	12	4.0	425	440	850	308	1566

Swing Check Valve

HVCH25

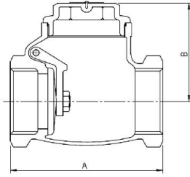

Technical data:

- BS 5154:1991
- Body material Bronze
- Max operating pressure: 25 bar at 100 °C
- Max operating temperature: 180 °C at 10 bar
- Min operating temperature: -10 °C
- Connection thread: ISO 7-1 Rc



Part number	DN	Rc	A	B
HVCH25-01	15	½	66	45
HVCH25-02	20	¾	70	49
HVCH25-03	25	1	83	58
HVCH25-04	32	1¼	96	65
HVCH25-05	40	1½	108	73
HVCH25-06	50	2	128	89

Spring Check Valve

2622

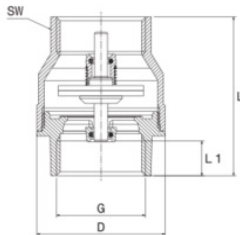

Technical data:

- BS EN 13959
- Body material Brass
- Max operating pressure: 25 bar
- Max operating temperature: 100 °C
- Connection thread: ISO 228-1



Part number	DN	G	L	L1	D	Sw
1 2622 41	15	½	47	9.6	29	25
1 2622 42	20	¾	52	11.2	38	31
1 2622 43	25	1	62	13.5	48	38
1 2622 44	32	1¼	65	12.5	56	47
1 2622 45	40	1½	73	14.5	69	54
1 2622 46	50	2	80	16	83	66

2. GENERAL VALVES

Flanged Swing Check Valve

2622

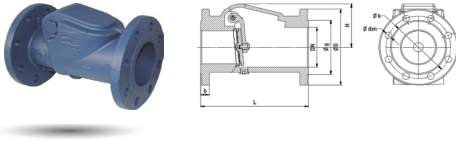

Technical data:

- BS EN 12334
- Body material Cast Iron
- Max operating pressure: 16 bar
- Max operating temperature: 120 °C
- Min operating temperature: -10 °C
- Flanged to BS EN 1092-2 PN16



Part number	DN	L	H	D	k	g	b	d	n
4 2622 21	65	240	87	185	145	118	20	19	4
4 2622 22	80	260	104	200	160	132	22	19	8
4 2622 23	100	300	125	220	180	156	24	19	8
4 2622 24	125	350	157	250	210	184	26	19	8
4 2622 25	150	400	186	285	140	211	26	23	8
4 2622 26	200	500	240	340	295	266	20	23	12
4 2622 27	250	600	295	405	355	319	22	28	12
4 2622 28	300	700	372	460	410	370	25	28	12

Wafer Check Valve

2622

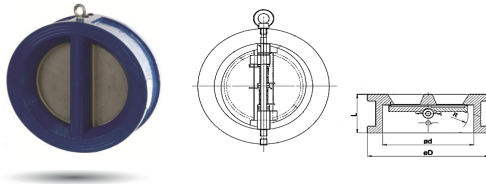

Technical data:

- BS EN 1266-1
- Body material Cast Iron
- Max operating pressure: 16 bar
- Max operating temperature: 120 °C
- Min operating temperature: -10 °C
- Flanged to BS EN 1092-2 PN16



Part number	DN	Dim.	L	Ød	ØD	R
4 2622 31	65	2 1/2	46	73	127	36
4 2622 32	80	3	64	89	142	45
4 2622 33	100	4	64	114	160	56
4 2622 34	125	5	70	141	192	70
4 2622 35	150	6	76	168	213	83
4 2622 36	200	8	89	219	270	105
4 2622 37	250	10	114	273	334	135
4 2622 38	300	12	114	324	380	156

Automatic Air Vent

2630

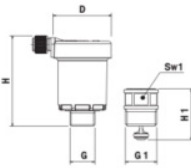

Technical data:

- Body material Brass
- Max operating pressure: 10 bar
- Max operating temperature: 110 °C
- Min operating temperature: 0 °C



Part number	DN	D	G	G1	H	H1	Sw	Sw1
1 2630 00	10	40	¾	¾	56	30	38	22
1 2630 01	15	40	¾	½	56	26	38	22

Air & Dirt separator

1124

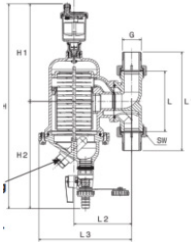

Technical data:

- Body material DZR
- Max operating pressure: 10 bar
- Max operating temperature: 110 °C
- Connection thread: ISO 228-1



Part number	DN	G	L	L1	L2	L3	H	H1	H2	SW
I 1124 02	20	¾	110	210	100	161	373	178	195	47
I 1124 03	25	1	110	180	100	161	373	178	195	47

Flanged Air & Dirt separator

HVADS

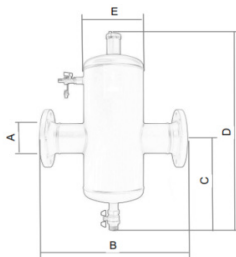

Technical data:

- Body material carbon steel
- Max operating pressure: 10 bar
- Max operating temperature: 95 °C
- Minimum particle size: 11 µm
- Flanged to BS EN 1092-2 PN16



Part number	DN	A	B	C	D	E
HVADS-21	50	50	420	343	668	169
HVADS-22	65	65	420	343	668	169
HVADS-23	80	80	500	368	773	220
HVADS-24	100	100	504	368	773	220
HVADS-25	125	125	635	478	993	324
HVADS-26	150	150	635	478	993	324
HVADS-27	200	200	766	525	1083	400

2. GENERAL VALVES

Brass Drain Cock

4119

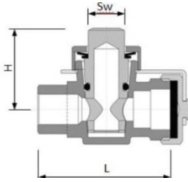

Technical data:

- Body material Brass
- Max operating pressure: 10 bar
- Max operating temperature: 110 °C
- Connection thread: ISO 228-1



Part number	DN	G	L	H	Sw
1 4119 01	15	½	54	38	12
1 4119 02	20	¾	65	41	12

Brass Hose Union Ball Valve

2512

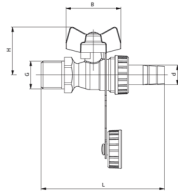

Technical data:

- UK Water Reg 4 Compliant
- Body material Brass
- Max operating pressure: 10 bar
- Max operating temperature: 110 °C
- Connection thread: ISO 228-1



Part number	DN	G	L	d	H	B	Sw
1 2512 01	15	½	83	15	37	40	24
1 2512 02	20	¾	98	19	40	40	30

Bronze Drain Tap

HV2879

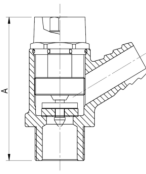

Technical data:

- Body material Bronze
- Max operating pressure: 13 bar
- Max operating temperature: 120 °C
- Connection thread: BSPT



Part number	DN	Dim.	A
HV2879-01	15	½	55
HV2879-02	20	¾	65

Differential Pressure Overflow Valve

4004

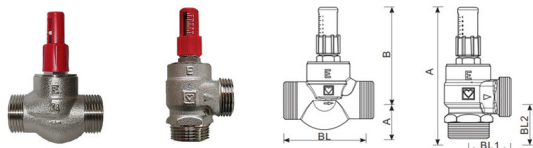

Technical data:

- Body material Brass
 - Max operating pressure: 10 bar
 - Max operating temperature: 120 °C
 - Min operating temperature: 0 °C
 - Connection thread: ISO 228-1
- Connections to be ordered separately



Part number	DN	Model	Threaded connection	A	B	BL	BL1	BL2
1 4004 31	15	straight	G ¾	26	82	69,5	-	-
1 4004 32	20	straight	G 1	26	82	75	-	-
1 4004 41	15	angle	G ¾	101	-	-	32	25
1 4004 42	20	angle	G 1	111	-	-	34	34,5

End Connections for 4004

6220



6236



Part number Steel	Part number Copper	Size	Cu	Thread R	SW
1 6220 21	1 6236 11	DN15	15	½"	30
1 6220 12	1 6236 22	DN20	22	¾"	36

Technical data:

- Material: Nickel plated brass
- Max operating pressure: 10 bar
- Max operating temperature: 110 °C

Pressure Relief Safety Valve

26xx

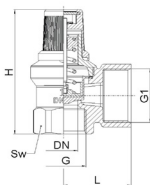

Technical data:

- EN ISO 4126
- Body material Brass
- Max operating pressure: as per table
- Max operating temperature: 110 °C
- Min operating temperature: 0 °C
- Connection thread: ISO 228-1



Part number	DN	Outlet pressure	Boiler output	G	G1	L	H	Sw
1 2611 01	15	2.5 bar	75 W	½	¾	32	72	27
1 2612 01	15	3 bar	75 W	½	¾	32	72	27
1 2615 01	15	4 bar	75 W	½	¾	32	72	27
1 2613 01	15	6 bar	75 W	½	¾	32	72	27
1 2618 02	20	1.8 bar	100 W	¾	1	35	72	32
1 2604 02	20	2.5 bar	100 W	¾	1	35	72	32
1 2605 02	20	3 bar	100 W	¾	1	35	72	32
1 2606 02	20	6 bar	150 W	¾	1	35	72	32
1 2607 03	25	2.5 bar	200 W	1	1¼	50	97	41
1 2608 03	25	3 bar	200 W	1	1¼	50	97	41
1 2647 03	25	4 bar	200 W	1	1¼	50	97	41
1 2657 03	25	5 bar	200 W	1	1¼	50	97	41
1 2667 03	25	6 bar	200 W	1	1¼	50	97	41
1 2687 03	25	8 bar	200 W	1	1¼	50	97	41
1 2697 03	25	10 bar	200 W	1	1¼	50	97	41
1 2609 04	32	2.5 bar	350 W	1¼	1½	52	97	50
1 2610 04	32	3 bar	350 W	1¼	1½	52	97	50
1 2669 04	32	6 bar	350 W	1¼	1½	52	97	50
1 2689 04	32	8 bar	350 W	1¼	1½	52	97	50

2. GENERAL VALVES

Gas Ball Valve

2300

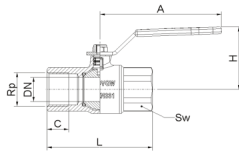

Technical data:

- EN331
- Body material Brass
- Max operating pressure: For MOP5 gas PN1 (HTB 650 °C/30min)
- Max operating temperature: 60 °C
- Min operating temperature: -20 °C
- Connection thread: ISO 228-1



Part number	DN	Rp - R	A	C	H	L	Sw
1 2300 01	15	1/2	90	15	47	75	26
1 2300 02	20	3/4	90	16.3	49	80	32
1 2300 03	25	1	135	19.1	61	90	41
1 2300 04	32	1 1/4	135	21.4	65	110	50
1 2300 05	40	1 1/2	180	21.4	84	120	55
1 2300 06	50	2	180	25.7	90	140	70

Tee handle for 2300 0x

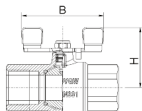

Part number	To suit	DN	B	H
2126629R	DN15 & 20	15	60	42
2126629R	DN15 & 20	20	60	45
2144630R	DN25 & 32	25	85	63
2144630R	DN25 & 32	32	85	67

Gas Fully-lugged Lever Butterfly Valve

HV-BF-FLL-GAS

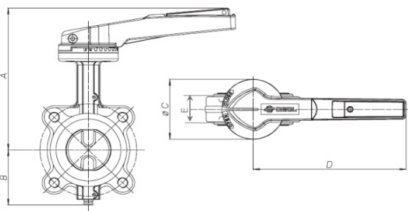

Technical data:

- DVGW Gas Approved to EN13774:2003
- EN 593
- Body material Ductile Iron
- Max operating pressure: 16 bar
- Max operating temperature: 82 °C
- Min operating temperature: -20 °C
- End flange: BS EN 1092-2 PN16

Part number	DN	A	B	ØC	D	E
HV-BF-FLL-GAS-06	50	203	80	90	160	43
HV-BF-FLL-GAS-07	65	225	86	90	220	46
HV-BF-FLL-GAS-08	80	230	95.5	90	220	49
HV-BF-FLL-GAS-09	100	250	108	90	220	49
HV-BF-FLL-GAS-10	125	277	124.5	90	350	56
HV-BF-FLL-GAS-11	150	290	137	90	350	56
HV-BF-FLL-GAS-12	200	325	166	90	350	60
HV-BF-FLL-GAS-13	250	390	199	175	500	68
HV-BF-FLL-GAS-14	300	426	234	175	500	78

FODRV Pressfit Commissioning Valve

C4017 M

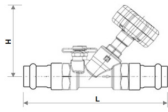
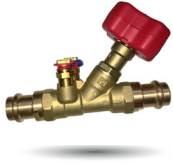

Technical data:

- BS 7350
- Body material DZR
- Max operating pressure: 16 bar
- Max operating temperature: 110 °C
- Connection: Conex >B< Press

Part number	DN	C	H	L	Kvs valve	Kvs Orifice
C 4017 11	15 LF	70	96	157	0.46	0.48
C 4017 21	15 MF	70	96	157	0.88	0.97
C 4017 01	15	70	96	157	2.00	1.95
C 4017 02	20	70	99	165	3.60	3.95
C 4017 03	25	70	109	184	6.50	7.90
C 4017 04	32	70	117	498	13.30	15.75
C 4017 05	40	70	136	245	18.50	21.50
C 4017 06	50	70	140	282	33.00	46.70

Pressfit Double Regulating Valve (DRV)

C4017 R

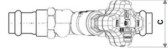
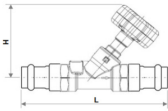

Technical data:

- UK Water Reg 4 Compliant
- Body material DZR
- Max operating pressure: 16 bar
- Max operating temperature: 110 °C
- Connection: Conex >B< Press



Part number	DN	L1	L2	H1	H2	M	D	Kvs valve
C 4017 61	15	83	129	96	109	25	70	2.00
C 4017 62	20	91	135	99	115	25	70	3.60
C 4017 63	25	110	146	109	130	25	70	6.50
C 4017 64	32	122	159	117	142	25	70	13.30
C 4017 65	40	135	178	136	163	25	70	18.50
C 4017 66	50	164	197	140	175	25	70	33.00

2. GENERAL VALVES

Pressfit Ball Valve

C2190

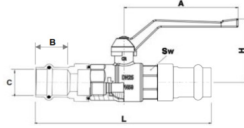

Technical data:

- UK Water Reg 4 Compliant
- Body material DZR
- Max operating pressure: 16 bar
- Max operating temperature: 110 °C
- Min operating temperature: -10 °C
- Connection: Conex >B< Press



Part number	DN	A	B	C	H	L	SW	kvs
C 2190 01	15	90	24	15	53	133	25	17
C 2190 02	20	90	24	22	56	139	32	34
C 2190 03	25	135	26	28	77	155	41	55
C 2190 04	32	135	26	35	81	167	48	102
C 2190 05	40	180	41	42	95	214	55	165
C 2190 06	50	180	43	54	101	244	70	270

Pressfit Strainer

C2662

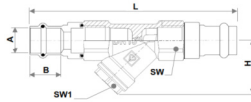

Technical data:

- UK Water Reg 4 Compliant
- Body material DZR
- Max operating pressure: 16 bar
- Max operating temperature: 110 °C
- Min operating temperature: -10 °C
- Connection: Conex >B< Press
- Mesh size 0.5mm



Part number	DN	A	B	H	L	SW	SW1	kvs
C 2662 11	15	15	24	37	142	25	22	2.6
C 2662 12	20	22	24	46	154	32	24	5.6
C 2662 13	25	28	26	55	164	41	25	8.2
C 2662 14	32	35	26	62	169	47	32	16.5
C 2662 15	40	42	41	69	215	54	36	27.4
C 2662 16	50	54	43	83	243	67	46	36.7

Pressfit Thermal Balancing Valve CTC

C4011

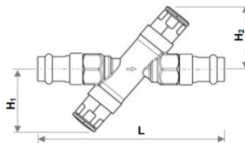

Technical data

- UK Water Reg 4 Compliant
- Body material DZR
- Max operating pressure: 10 bar
- Max operating temperature: 80 °C
- Regulating temperature: 55 °C
- Connection: Conex >B< Press



Part number	DN	H1	H2	L	Kvs
C 4011 11	15	55	56	155	2.55
C 4011 12	20	51	54	176	5.60

Pressfit Male Thread Connection

C6251

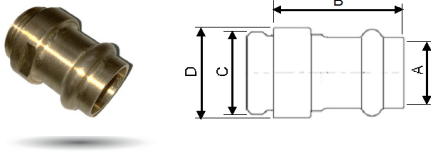

Technical data:

- UK Water Reg 4 Compliant
- Body material Gunmetal
- Seals EPDM
- Max operating pressure: 16 bar
- Max operating temperature: 110 °C
- Min operating temperature: -10 °C
- Connection: Conex >B< Press



Part number	DN	A	B	C	D
C 6251 01	15	15	37	½	27
C 6251 02	20	22	37	¾	32
C 6251 03	25	28	37	1	39
C 6251 04	32	35	38	1¼	47
C 6251 05	40	42	55	1½	55
C 6251 06	50	54	59	2	68

Pressfit Flat Faced Union Connection

C6252

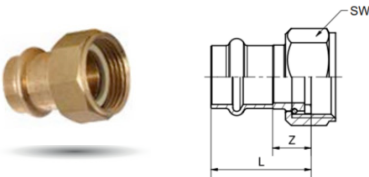

Technical data:

- Body material Gunmetal
- Seals EPDM
- Max operating pressure: 16 bar
- Max operating temperature: 110 °C
- Min operating temperature: -10 °C
- Connection: Conex >B< Press



Part number	DN	Cu Size	L	Z	SW
C 6252 01	15	15	37	½	27
C 6252 02	20	22	37	¾	32
C 6252 03	25	28	37	1	39
C 6252 04	32	35	38	1¼	47
C 6252 05	40	42	55	1½	55
C 6252 06	50	54	59	2	68

3. TEMPERATURE CONTROL

CALIS-TS Thermostatic 3 Port Valve

7761

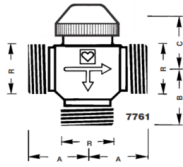

Technical data:

- Body material Brass Nickel plated
- Max operating pressure: 10 bar
- Max operating temperature: 110 °C
- Head mounting connection: M28 x 1.5
- Connection thread: Flat seal ISO 228-1

Connections and actuators to be ordered separately see below and page 13



Part number	DN	R	A	B	C	Kvs
1 7761 01	15	¾	30	30	22	2.75
1 7761 02	20	1	37.5	34	22	3.2

CALIS-TS-RD Thermostatic 3 Port Valve [100% Distribution]

7761

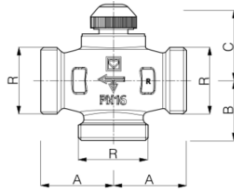

Technical data:

- Body material Brass
- Max operating pressure: 10 bar
- Max operating temperature: 110 °C
- Head mounting connection: M28 x 1.5
- Connection thread: Flat seal ISO 228-1

Connections and actuators to be ordered separately see below and page 13



Part number	DN	R	A	B	C	Kvs
1 7761 38	15	¾	30	30	22	3.0
1 7761 39	20	1	37.5	34	22	3.0
1 7761 40	25	1¼	45	43	40.5	6.27
1 7761 41	32	1½	50	43	40.5	6.44

Thermostatic Contact Sensor & Immersion Pocket

7420/7421

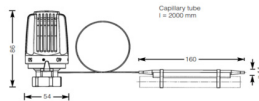

6313



Part number	Temperature range	Capillary length	Mounting thread
1 7420 06	20 - 50 °C	2 m	M28 x 1.5
1 7421 00	40 - 70 °C	2 m	M28 x 1.5

Part number	Thread
1 6313 01	1/2

End Connections for 7761 CALIS Valves

6220



6236



Steel Conns Part number	Copper Conns Part number	Size	Thread R	Cu size
1 6220 21	1 6236 11	DN15	½	15
1 6220 12	1 6236 22	DN20	¾	22
1 6220 63	1 6236 63	DN25	1	28
1 6220 64	1 6236 64	DN32	1¼	35

Zone Valve

7723

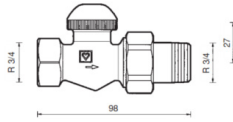

Technical data:

- Body material Brass
- Max. operating temperature: 120 °C
- Max. operating pressure: 10 bar

Actuators to be ordered separately see page 13



Part number	DN	Kvs
1 7723 82	20	1.9

Thermostatic Control Valve

7217

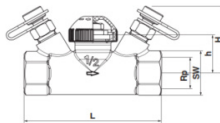

Technical data:

- Body material DZR
- Max. operating temperature: 130 °C
- Max. operating pressure: 10 bar
- Max. differential pressure: 0.2 bar

Actuators to be ordered separately see page 13



Part number	Type	DN	L	Rp	H	h	SW	Kvs
1 7217 37	TS-98-V	15	92	1/2	65	41	27	1.1
1 7217 38	TS-99-FV	15	92	1/2	65	41	27	0.4

FODRV Zone/Control Valve

7217 V

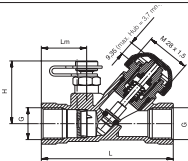

Technical data:

- Body material DZR
- Max. operating temperature: 130 °C
- Max. operating pressure: 20 bar
- Max. differential pressure on the seat: 10 bar

Actuators to be ordered separately see page 13



Part number	Type	DN	L	Lm	Rp	H	SW	Kv	Kvs
1 7217 50	TS-V LF	15	83	28.5	1/2	41	27	0.07 - 0.45	0.48
1 7217 59	TS-V MF	15	83	28.5	1/2	41	27	0.30 - 0.90	0.97
1 7217 51	TS-V	15	83	28.5	1/2	41	27	0.45 - 1.70	1.95
1 7217 52	TS-V	20	91	31	3/4	41	32	0.40 - 3.40	3.95

VODRV Zone/Control Valve

7217 GV

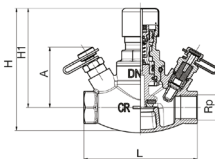

Technical data:

- Body material DZR
- Max. operating pressure: 16 bar
- Max. diff. pressure on the body: 4 bar
- Max. diff. pressure on the seat: 4 bar
- Max. operating temperature: 130 °C
- Min. operating temperature: -20 °C

Actuators to be ordered separately see page 13



Part number	Type	DN	L	Lm	Rp	H	SW	Kv	Kvs
1 7217 71	TS-V LF	15	83	28.5	1/2	41	27	0.07 - 0.45	0.48
1 7217 72	TS-V MF	15	83	28.5	1/2	41	27	0.30 - 0.90	0.97
1 7217 73	TS-V	15	83	28.5	1/2	41	27	0.45 - 1.70	1.95

3. TEMPERATURE CONTROL

2 Port Control Valves

7760

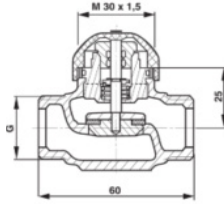

Technical data:

- Body material Brass
- Max operating pressure: 16 bar
- Max operating temperature: 120 °C
- Head mounting connection: M30 x 1,5
- Connection thread: Flat seal ISO 228-1

Connections and actuators to be ordered separately see below and page 13 respectively



Part number	DN	G	Kvs	Stroke [mm]
1 7760 05	15	¾	2.5	4
1 7760 07	15	¾	4.0	4
1 7760 08	20	1	5.0	4

3 Port Control Valves

7762

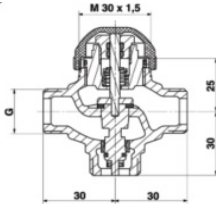

Technical data:

- Body material Brass
- Max operating pressure: 16 bar
- Max operating temperature: 120 °C
- Head mounting connection: M30 x 1,5
- Connection thread: Flat seal ISO 228-1

Connections and actuators to be ordered separately see below and page 13 respectively



Part number	DN	G	Kvs-value straight flow	Kvs-value bypass flow	Stroke [mm]	H
1 7762 51	15	¾	2.5	1.9	3.7	40
1 7762 61	15	¾	4.0	3.0	3.7	40
1 7762 62	20	1	5.0	3.8	3.7	40

4 Port Control Valves

7763

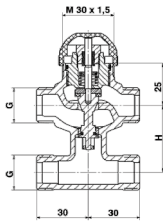

7763

Technical data:

- Body material Brass
- Max operating pressure: 16 bar
- Max operating temperature: 120 °C
- Head mounting connection: M30 x 1,5
- Connection thread: Flat seal ISO 228-1

Connections and actuators to be ordered separately see below and page 13 respectively



Part number	DN	G	Kvs-value straight flow	Kvs-value bypass flow	Stroke [mm]	H
1 7763 51	15	¾	2.5	1.9	3.7	40
1 7763 61	15	¾	4.0	3.0	3.7	40
1 7763 62	20	1	5.0	3.8	3.7	40

End Connections for 7760, 7762 & 7763 Control Valves

6220



6236



Steel Conns Part number	Copper Conns Part number	Size	Thread R	Cu size
1 6220 21	1 6236 11	DN15	½	15
1 6220 12	1 6236 22	DN20	¾	22

Flanged 2 Port Control Valve

F4035

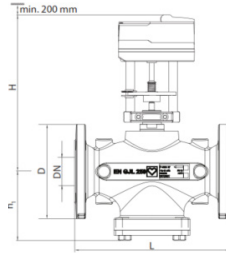
**Technical data:**

- Body material Cast Iron
 - Max. operating pressure: 16 bar
 - Max. operating temperature: 150 °C
 - Min. operating temperature: 5 °C
 - Valve characteristic: equal percentage
 - Flanged to BS EN 1092-2 PN16
- Actuators to be ordered separately see page 15



Part number	DN	D	L	h_1	H	Stroke	DP max.	Kvs
F 4035 07	65	185	290	135	315	20	1.5 bar	63
F 4035 08	80	200	310	150	350	20	1.5 bar	100
F 4035 09	100	220	350	160	480	40	2 bar	160
F 4035 10	125	250	400	185	520	40	1 bar	250
F 4035 41	150	285	480	180	525	40	1 bar	330

Flanged 3 Port Control Valve

F4037

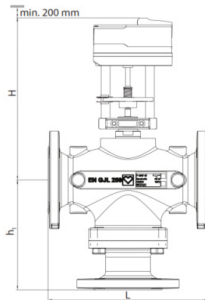
**Technical data:**

- Body material Cast Iron
 - Max. operating pressure: 16 bar
 - Max. operating temperature: 150 °C
 - Min. operating temperature: 5 °C
 - Valve characteristic: equal percentage
 - Flanged to BS EN 1092-2 PN16
- Actuators to be ordered separately see page 15



Part number	DN	D	L	h_1	H	Stroke	DP max.	Kvs
F 4037 07	65	185	290	208	315	20	1.5 bar	63
F 4037 08	80	200	310	233	350	20	1 bar	100
F 4037 09	100	220	350	262	480	40	2 bar	160
F 4037 10	125	250	400	268	520	40	0.9 bar	250
F 4037 41	150	285	480	261	525	40	0.9 bar	330

F4035 & F4037 Actuator Selection

DN	230V 2/3 point		24V 2/3 point		24V Modulating 10V DC	
	F 7712 82	F 7712 84	F 7712 96	F 7712 98	F 7112 91	F 7712 92
50	●	-	●	-	●	-
65	●	-	●	-	●	-
80	-	●	-	●	-	●
100	-	●	-	●	-	●
125	-	●	-	●	-	●
150	-	●	-	●	-	●

3. TEMPERATURE CONTROL

3 Port Mixing and Diverting Valve

4037

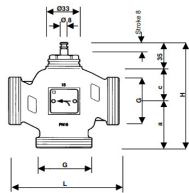

Technical data:

- Max operating temperature: 130°C up to DN32, 110°C from DN40
- Max. operating pressure: 16 bar
- Valve characteristic: linear

Connections and actuators to be ordered separately



Part number	DN	G	a	c	L	H	DP max.	Kvs
1 4037 15	15	G 1	50	32	100	117	4 bar	4
1 4037 20	20	G 1½	50	33	100	118	3 bar	6.3
1 4037 25	25	G 1½	55	36	110	126	2 bar	10
1 4037 32	32	G 2	60	38	120	133	1.5 bar	16
1 4037 40	40	G 2½	70	48	130	153	1 bar	25
1 4037 50	50	G 2¾	75	54	150	164	0.8 bar	40

End Connections for 4037

6220

6236



Steel Conns Part number	Copper Conns Part number	Size	Thread R	Cu size
1 6221 02	1 6236 02	DN15	½	15
1 6220 63	1 6236 63	DN20	¾	22
1 6220 64	1 6236 64	DN25	1¼	35
1 6220 74	1 6236 74	DN32	1¼	35
1 6220 75	1 6236 75	DN40	1½	42
1 6220 76	1 6236 76	DN50	2	54

Motorised Actuator for 4037 3 Port Valve

7712

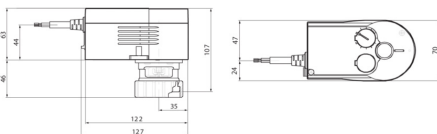

Technical Data

- CE to EN 60730
- 2/3-point control (1771250/51)
- 2/3-point control or Modulating 0-10VDC (1771211)
- IP 54



Part number	Control	Nominal voltage	Actuating force	Stroke [mm]	Degree of protection IEC/EN
1 7712 50	-	230 V	500 N	8	IP54
1 7712 51	-	24 V	500 N	8	IP54
1 7712 11	0-10V DC	24V	500 N	8	IP54

Analogue Room Thermostat

F799

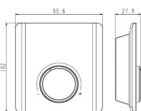

Technical data:

- Analogue room thermostat
- Temperature range: 10 - 28 °C
- Degree of protection: IP20



Part number	Nominal voltage	Temperature range	Degree of protection IEC/EN	Heating/Cooling
3 F799 11	230V/AC	10 - 28 °C	IP20	Heating
3 F799 12	24V/AC	10 - 28 °C	IP20	Heating
3 F799 13	230V/AC	10 - 28 °C	IP20	Heating/Cooling
3 F799 14	24V/AC	10 - 28 °C	IP20	Heating/Cooling

2 Port Control Ball Valve

2117

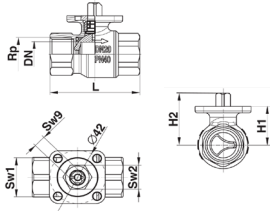

Technical data:

- Body material DZR
- Max. operating temperature: 110 °C
- Min. operating temperature: -10 °C
- Max. operating pressure: as per table
- Female threads acc. to ISO 7-1

Actuators to be ordered separately

Part number	DN	PN	Rp	L	H1	H2	SW1	SW2	Kvs
1 2117 11	15	40	½	60	27.5	38	25	19	5
1 2117 12	20	40	¾	68	30.5	41	31	19	8
1 2117 13	25	40	1	81	38	48.5	41	20	12.5
1 2117 14	32	25	1¼	95	41.5	52	51	20	20
1 2117 15	40	25	1½	106	47	57.5	55	20	32
1 2117 16	50	25	2	127	54.8	65.3	70	20	50

Motorised Actuator for 2117 Control Valves

7712

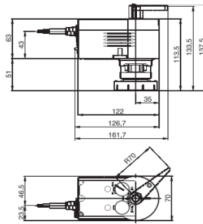

Technical data:

- CE to EN 61000-6-1, EN 61000-6-2, EN 61000-6-3, EN 61000-6-4
- Rotary actuator
- 2/3-point control (1771233)
- 2/3-point control - Modulating 0-10VDC (1771235)
- IP 54

Part number	Control	Nominal voltage	Torque	Degree of protection IEC/EN
1 7712 33		230 V / AC	8 Nm	IP54
1 7712 35	0-10V DC	24 V	8 Nm	IP54

Digital Room Thermostat

F799

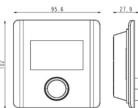

Technical data:

- Digital room thermostat
- Temperature range: 5 - 30 °C
- Degree of protection: IP20

Part number	Nominal voltage	Temperature range	Degree of protection IEC/EN	Heating/Cooling	Programmable	Floor Sensor
3 F799 15	230V/AC	5 - 30 °C	IP20	Heating	-	-
3 F799 16	24V/AC	5 - 30 °C	IP20	Heating	-	-
3 F799 17	230V/AC	5 - 30 °C	IP20	Heating/Cooling	7 day	Yes
3 F799 18	24V/AC	5 - 30 °C	IP20	Heating/Cooling	7 day	Yes

4. DOMESTIC WATER

Compression Ball Valve Red Lever

2190 4X

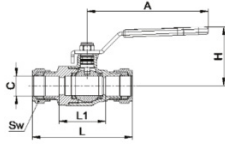

Technical data:

- UK Water Reg 4 Compliant
- Body material DZR
- Max operating pressure: 16 bar
- Max operating temperature: 120 °C
- Compression ends to BS EN 1254-2



Part number	DN	Cu	C	L	L1	H	A	Sw	kv
1 2190 41	15	15	15.2	76.5	35.5	47	90	24	17
1 2190 42	20	22	22.2	81	37	49	90	32	34
1 2190 43	25	28	28.1	95	44.4	61	135	37	55
1 2190 44	32	35	35.1	108.5	54.6	65	135	46	102
1 2190 45	40	42	42.2	122	60	84	180	60	165
1 2190 46	50	54	54.4	134	72	90	180	70	270

Compression Ball Valve Blue Lever

2190 5X

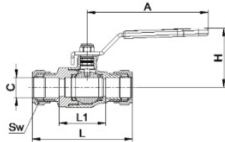

Technical data:

- UK Water Reg 4 Compliant
- Body material DZR
- Max operating pressure: 16 bar
- Max operating temperature: 120 °C
- Compression ends to BS EN 1254-2



Part number	DN	Cu	C	L	L1	H	A	Sw	kv
1 2190 51	15	15	15.2	76.5	35.5	47	90	24	17
1 2190 52	20	22	22.2	81	37	49	90	32	34
1 2190 53	25	28	28.1	95	44.4	61	135	37	55
1 2190 54	32	35	35.1	108.5	54.6	65	135	46	102
1 2190 55	40	42	42.2	122	60	84	180	60	165
1 2190 56	50	54	54.4	134	72	90	180	70	270

The full range of UK Water Reg 4 Compliant ball valves can be found in Section 2 General Valves

Ball Valve with Tee handle

2206 Red Tee



2206 Blue Tee

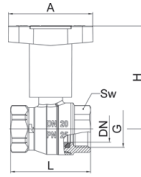

Technical data:

- UK Water Reg 4 Compliant
- Body material DZR
- Max operating pressure: 25 bar
- Max operating temperature: 150 °C
- Min operating temperature: -30 °C
- Connection thread: ISO 228-1



Part number Red handle	Part number Blue handle	DN	PN	G	L	H	A	Sw
1 2206 41	1 2206 51	15	25	½	51	70	60	25
1 2206 42	1 2206 52	20	25	¾	57	73	60	31
1 2206 43	1 2206 53	25	25	1	73	82	85	39
1 2206 44	1 2206 54	32	25	1¼	84	88	85	48
1 2206 45	1 2206 55	40	25	1½	95	120	120	55
1 2206 46	1 2206 56	50	25	2	112	126	120	70

Service Ball Valve

HVSBV

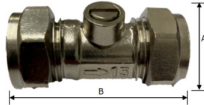

Technical data:

- UK Water Reg 4 Compliant
- Body material Brass chrome plated
- Max operating pressure: 10 bar
- Max operating temperature: 65 °C
- Compression ends to BS EN 1254-2



Part number	DN	Cu	A	B
HVSBV-01	15	15	26	50
HVSBV-02	20	22	35	63

Flow Restrictor Service Ball Valve

TMVBVFR

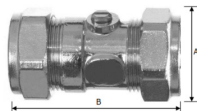

Technical data:

- UK Water Reg 4 Compliant
- Body material Brass chrome plated
- Max operating pressure: 16 bar at 30 °C
- Max operating temperature: 120 °C at 5 bar
- Compression ends to BS EN 1254-2



Part number	DN	Cu	Flowrate	A	B
TMVBV15FR4	15	15	4 l/min	26	55
TMVBV15FR6	15	15	6 l/min	26	55
TMVBV15FR8	15	15	8 l/min	26	55
TMVBV15FR10	15	15	10 l/min	26	55
TMVBV15FR12	15	15	12 l/min	26	55
TMVBV15FR15	15	15	15 l/min	26	55

4. DOMESTIC WATER

Thermal Balancing Valve CTC

4011

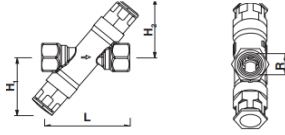

Technical data:

- UK Water Reg 4 Compliant
- Body material DZR
- Max operating pressure: 10 bar
- Max operating temperature: 80 °C
- Regulating temperature: 55 °C



Part number	DN	Rp	L	H ₁	H ₂	kvs
2 4011 11	15	½"	81	55	56	0.45
2 4011 12	20	¾"	102	51	54	0.45

Pressfit Thermal Balancing Valve CTC

C4011

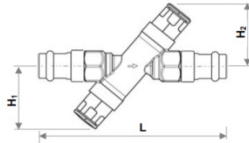

Technical data

- UK Water Reg 4 Compliant
- Body material DZR
- Max operating pressure: 10 bar
- Max operating temperature: 80 °C
- Regulating temperature: 55 °C
- Connection: Conex >B< Press



Part number	DN	H1	H2	L	Kvs
C 4011 11	15	55	56	155	2.55
C 4011 12	20	51	54	176	5.60

Partner Ball Valve with Tee handle and temperature gauge

2206 Red Tee

2206 Blue Tee

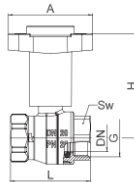

Technical data:

- UK Water Reg 4 Compliant
- Body material DZR
- Max operating pressure: 25 bar
- Max operating temperature: 150 °C
- Min operating temperature: -30 °C
- Connection thread: ISO 228-1



Part number Red handle	Part number Blue handle	DN	PN	G	L	H	A	Sw
1 2206 61	1 2206 71	15	25	½	51	70	60	25
1 2206 62	1 2206 72	20	25	¾	57	73	60	31
1 2206 63	1 2206 73	25	25	1	73	82	85	39
1 2206 64	1 2206 74	32	25	1¼	84	88	85	48
1 2206 65	1 2206 75	40	25	1½	95	120	120	55
1 2206 66	1 2206 76	50	25	2	112	126	120	70

HERZ Shield Thermostatic Mixing Valve TMV2 & TMV3

HVTMV

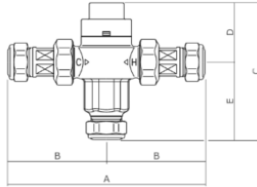

Technical data

- BS EN 1111
- BS EN 1287
- UK Water Reg 4 Compliant
- TMV2 & TMV3
- Body material DZR
- Max operating pressure: 10 bar
- Setting range: 30 to 50 °C



Part number	DN	Cu	A	B	C	D	E
HVTMV-15	15	15	141	67.5	99	43	56
HVTMV-22	20	22	150	75	100	43	57

Herz Shield Plus Thermostatic Mixing Valve TMV2 & TMV3 with isolation

HVTMV-IV

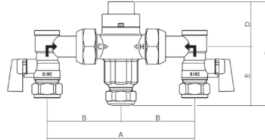

Technical data

- BS EN 1111
- BS EN 1287
- UK Water Reg 4 Compliant
- TMV2 & TMV3
- Body material DZR
- Max operating pressure: 10 bar
- Setting range: 30 to 50 °C



Part number	DN	Cu	A	B	C	D	E
HVTMV-15IV	15	15	141	67.5	99	43	56
HVTMV-22IV	20	22	150	75	100	43	57

Double Regulating Valve (DRV)

4017 R

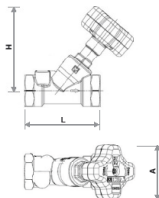

Technical data:

- BS 7350
- Body material DZR
- Max operating pressure: 20 bar
- Max operating temperature: 130 °C
- Connection thread: ISO 228-1



Part number	DN	A	L	H	Kvs valve
1 4017 61	15	70	83	96	2.00
1 4017 62	20	70	91	99	3.60
1 4017 63	25	70	110	109	6.50
1 4017 64	32	70	122	117	13.30
1 4017 65	40	70	135	136	18.50
1 4017 66	50	70	164	140	33.00

4. DOMESTIC WATER

Pressure Reducing Valve

2682

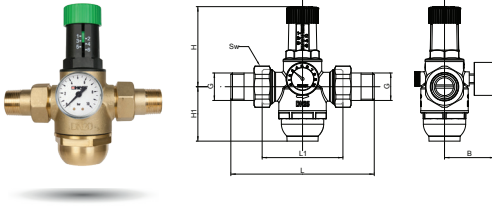

Technical data:

- UK Water Reg 4 Compliant
- Body material DZR
- Max inlet pressure: 16 bar
- Outlet pressure range: 1.75 – 6 bar
- Max operating temperature: 70 °C
- Connection thread: ISO 7/1



Part number	DN	G	L	L1	B	H	H1	Sw
1 2682 21	15	½	147	84	67	98	66	30
1 2682 22	20	¾	155	84	67	98	66	37
1 2682 23	25	1	185	98	67	98	66	46
1 2682 24	32	1¼	204	120	77.5	156	96	52
1 2682 25	40	1½	224	122	77.5	156	96	60
1 2682 26	50	2	252	136	77.5	156	96	75

Pressure Reducing Valve Compression

HVPRVC

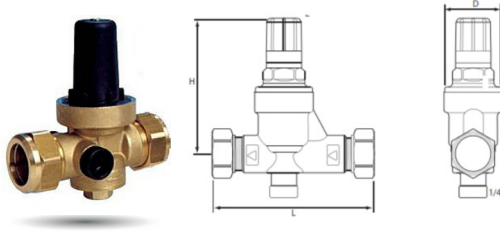

Technical data:

- UK Water Reg 4 Compliant
- Body material DZR
- Max inlet pressure: 16 bar
- Outlet pressure range: 1.5 – 5.5 bar
- Max operating temperature: 85 °C
- Compression ends to BS EN 1254-2



Part number	DN	Cu	L	L1	B	H	H1	Sw
HVPRVC-11	15	15	133	84	61	98	66	30
HVPRVC-12	20	22	141	84	61	98	66	39

Pressure Reducing Valve Flanged

HVPRVF

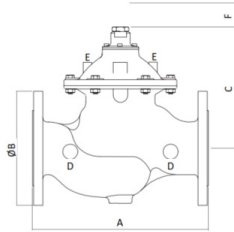

Technical data:

- UK Water Reg 4 Compliant
- Body material Ductile iron
- Max inlet pressure: 16 bar
- Outlet pressure range: 0.5 – 8 bar
- Max operating temperature: 85 °C
- Flanged to BS EN 1092-2 PN16



Part number	DN	A	B	C	D NPT	E NPT	F
HVPRVF-07	65	292	185	185	½	¼	140
HVPRVF-08	80	310	200	230	½	¼	170
HVPRVF-09	100	350	220	240	½	¼	180
HVPRVF-11	150	480	285	330	½	¼ & ½	230
HVPRVF-12	200	600	345	390	½	½	300
HVPRVF-13	250	730	410	520	½	½	390
HVPRVF-14	300	850	460	635	½	½	450

4. DOMESTIC WATER

Single Check Valve

HVSCV

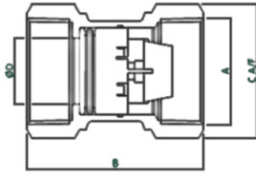

Technical data:

- BS EN 13959
- UK Water Reg 4 Compliant
- Body material DZR
- Max operating pressure: 10 bar
- Max operating temperature: 90 °C
- Connection thread: BS EN 10226-2

Part number	DN	A [Rc]	B	C A/F	D
HVSCV-21	15	½	42	24	12,5
HVSCV-22	20	¾	50	32	17
HVSCV-23	25	1	60	38	22
HVSCV-24	32	1¼	79	46	24
HVSCV-25	40	1½	84	53	30
HVSCV-26	50	2	101	64	38

Single Check Valve Compression

HVSCVC

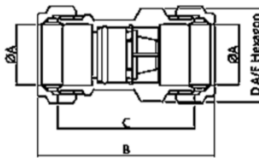

Technical data:

- BS EN 13959
- UK Water Reg 4 Compliant
- Body material DZR chrome plated
- Max operating pressure: 10 bar
- Max operating temperature: 85 °C
- Compression ends to BS EN 1254-2

Part number	DN	ØA	B	C	D A/F
HVSCVC-31	15	15mm	61	45.5	22
HVSCVC-32	20	22mm	65	50	31.5
HVSCVC-33	25	28mm	72	56.5	39

Double Check Valve

HVDCV

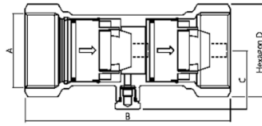

Technical data:

- BS EN 13959
- UK Water Reg 4 Compliant
- Body material DZR
- Max operating pressure: 10 bar
- Max operating temperature: 85 °C
- Connection thread: BS EN 10226-2

Part number	DN	A	B	C	D A/F
HVDCV-21	15	G ½	64	18	24
HVDCV-22	20	G ¾	78	21	32
HVDCV-23	25	G 1	94	25	38
HVDCV-24	32	Rc 1¼	121	26	46
HVDCV-25	40	Rc 1½	143	30	52
HVDCV-26	50	Rc 2	184	36	65

Double Check Valve Compression

HVDCVC

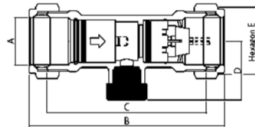

Technical data:

- BS EN 13959
- UK Water Reg 4 Compliant
- Body material Nickel plated DZR
- Max operating pressure: 10 bar
- Min inlet pressure 0.2 bar
- Max operating temperature: 85 °C
- Compression ends to BS EN 1254-2

Part number	DN	ØA	B	C	D	E A/F
HVDCVC-31	15	15mm	79	61.5	24.5	24
HVDCVC-32	20	22mm	92	75	27.5	31.5
HVDCVC-33	25	28mm	106	89	30.5	39

4. DOMESTIC WATER

DRZ Strainer

2662

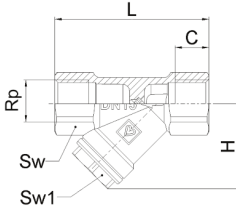

Technical data:

- UK Water Reg 4 Compliant
- Body material DZR
- Max operating pressure: 25 bar
- Max operating temperature: 130 °C
- Min operating temperature: -30 °C
- Connection thread: ISO 228-1
- Mesh size 0,5mm



Part number	DN	Rp	C	L	H	SW	SW1	Kvs
1 2662 11	15	½	15	68	37	25	22	2,55
1 2662 12	20	¾	16,3	80	46	32	24	5,60
1 2662 13	25	1	19	90	54	41	25	8,20
1 2662 14	32	1¼	14	93	62	47	32	16,5
1 2662 15	40	1½	16	105	69	54	36	27,4
1 2662 16	50	2	18	125	83	67	46	36,7

Flanged Strainer

HV185W

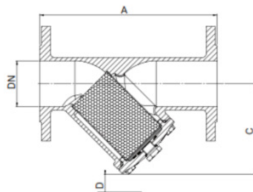

Technical data:

- UK Water Reg 4 Compliant
- Body material Ductile Iron
- Max operating pressure: 16 bar to DN150, 10 bar to DN300
- Max operating temperature: 100 °C
- Min operating temperature: -10 °C
- Mesh size: as per table
- Flanged to BS EN 1092-2 PN10



Part number	DN	A	C	D	mesh	kv
HV185W-07	65	290	137	65	0.8	89
HV185W-08	80	310	159	75	1.25	127
HV185W-09	100	350	187	90	1.25	200
HV185W-10	125	400	249	125	1.25	364
HV185W-11	150	480	301	170	1.25	494
HV185W-12	200	600	403	220	1.25	937
HV185W-13	250	730	472	200	1.6	1137
HV185W-14	300	850	508	250	1.6	1844

Solenoid Valve

HVSOLV

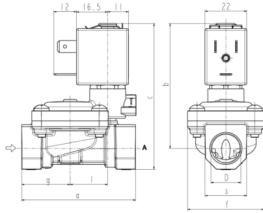

Technical data:

- UK Water Reg 4 Compliant
- Body material Brass
- Max operating pressure: 20 bar (DN15 - 25)
- Max operating pressure: 10 bar (DN32 - 50)
- Max operating temperature: 85°C
- Min operating temperature: -10°C
- Connection thread: ISO 228-1



Part number	DN	D	a	b	c	f	g	l	s	kvs
HVSOLV-01	15	½	66	68	82	40	29	20	27	3,8
HVSOLV-02	20	¾	79	72.5	89	50	35.5	24.5	33	5
HVSOLV-03	25	1	105	85	106	71	46	28	42	12
HVSOLV-04	32	1¼	113	106	132	81	50	40	52	15
HVSOLV-05	40	1½	140	110	140	110	64	53	60	27
HVSOLV-06	50	2	157	114	150	110	72	53	72	34

Solenoid Valve Commissioning Magnet

HVSOLV-MAG



Technical data:

- Magnet operator
- Pocket size
- Permanent magnet moulded in ABS plastic

Part number	DN	Dia
HVSOLV-MAG01	15-25	15mm
HVSOLV-MAG02	32-50	18mm

5. RADIATOR VALVES

Classic Thermostatic Sensor

7260 / 7230

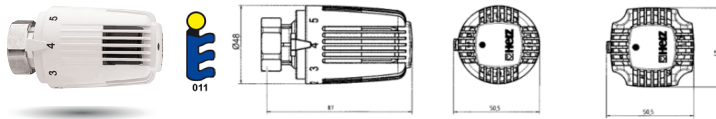

Part number	Description	Temp. range	Frost set	Mounting thread
1 7260 06	Standard	8 - 28 °C	8 °C	M28 x 1.5
1 7230 06	Quatro	0 - 30 °C	8 °C	M28 x 1.5
1 7230 22	Quatro SP22	0 - 22 °C	8 °C	M28 x 1.5
1 7262 00	High Lift for one pipe	8 - 25 °C	12 °C	M28 x 1.5

Design Thermostatic Sensor

9260 / 9230



Part number	Temp. range	Frost set	Mounting thread
1 9260 06	8 - 28 °C	8 °C	M28 x 1.5
1 9230 06	0 - 30 °C	8 °C	M28 x 1.5

Mini Design Thermostatic Sensor

9200

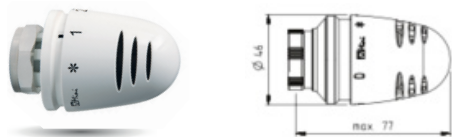

Part number	Temp. range	Frost set	Mounting thread
1 9200 30	0 - 30 °C	8 °C	M28 x 1.5

Limiting Pins

9551



Part number	Model
1 9551 00	General Limiting Pin
1 9551 02	Mini only Limiting Pin

Herzcules Vandal Resistant Thermostatic Sensor

9860 / 9861

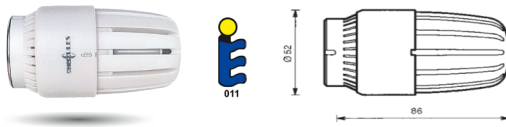

Part number	Temp. range	Frost set	Turn down	Mounting thread
1 9860 10	8 - 26 °C	8 °C	-	M28 x 1,5
1 9861 40	8 - 26 °C	8 °C	4°C	M28 x 1,5
1 9861 10	8 - 26 °C	8 °C	10°C	M28 x 1,5

9554



Part number	Model
1 9554 00	Herzcules Setting Tool
1 9554 01	Herzcules Tightening Tool

Design Remote Adjusting Thermostatic Sensor

9330

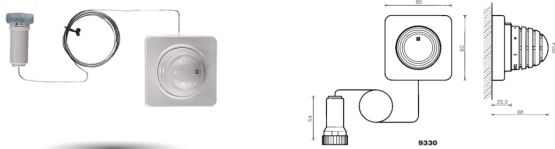

Part number	Temp. range	Frost set	Capillary length	Mounting thread
1 9330 05	2 - 28 °C	7 °C	2m	M28 x 1,5
1 9330 10	2 - 28 °C	7 °C	5m	M28 x 1,5
1 9330 18	2 - 28 °C	7 °C	8m	M28 x 1,5
1 9330 20	2 - 28 °C	7 °C	10m	M28 x 1,5

Design Remote Sensing Thermostatic Sensor

9430

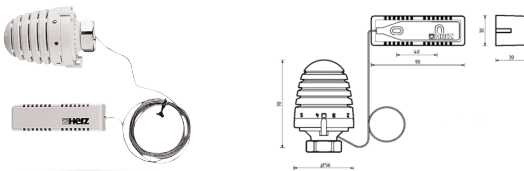

Part number	Temp. range	Frost set	Capillary length	Mounting thread
1 9430 08	0 - 30 °C	8 °C	2m	M28 x 1,5
1 9430 18	0 - 30 °C	8 °C	8m	M28 x 1,5
1 9460 06	8 - 28 °C	8 °C	2m	M28 x 1,5
1 9460 18	8 - 28 °C	8 °C	8m	M28 x 1,5

5. RADIATOR VALVES

TS-90 Thermostatic Valves

7723 - Straight

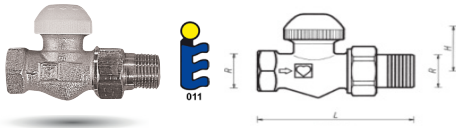

7724 - Angle

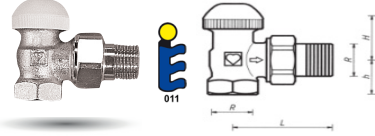

7728 - Reverse Angle

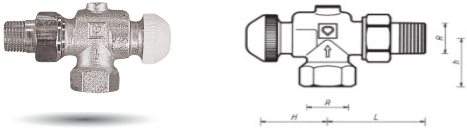

Technical data:

- Body material: Brass nickel plated
- Max operating pressure: 10 bar
- Max operating temperature: 120 °C
- Connection thread: ISO 228-1

7758 - 3 Axis



7759 - 3 Axis

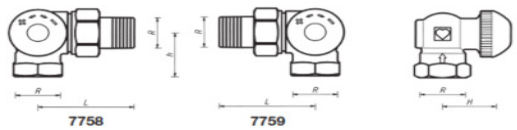
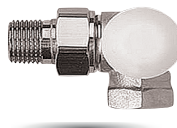

Part number	Model	DN	R	Female Connection	Male Connection	L	H	h	kv
1 7723 91	Straight	15	½	Rp ½	-	83	27	-	1.1
1 7723 92	Straight	20	¾	Rp ¾	-	98	27	-	1.9
1 7723 93	Straight	25	1	Rp 1	-	126	27	-	4.2
1 7724 91	Angle	15	½	Rp ½	-	54	23	23	1.1
1 7724 92	Angle	20	¾	Rp ¾	-	63	23	23	1.9
1 7724 93	Angle	25	1	Rp 1	-	70	23	33	4.2
1 7728 91	Reverse Angle	15	½	Rp ½	-	55	35	33	1.1
1 7728 97	Reverse Angle	20	¾	Rp ¾	-	66	32	33	1.9
1 7758 91	3 Axis LHS	15	½	Rp ½	-	53	26	31	1.1
1 7759 91	3 Axis RHS	15	½	Rp ½	-	53	26	31	1.1
1 7733 81	Straight	15	½	-	G ¾	84	27	-	1.1
1 7724 37	Angle	15	½	-	G ¾	54	23	24	1.1
1 7748 91	Reverse Angle	15	½	-	G ¾	55	35	34	1.1

Presettable TRV Rule of Thumb

kW load	10°Δt	15°Δt	20°Δt	25°Δt	30°Δt
0.2	TS-99-V	TS-99-V	TS-99-V	TS-99-V	TS-99-V
0.5	TS-99-V	TS-99-V	TS-99-V	TS-99-V	TS-99-V
1.0	TS-99-V	TS-99-V	TS-99-V	TS-99-V	TS-99-V
1.5	TS-99-V	TS-99-V	TS-99-V	TS-99-V	TS-99-V
2.0	TS-98-V	TS-99-V	TS-99-V	TS-99-V	TS-99-V
2.5	TS-98-V	TS-98-V	TS-99-V	TS-99-V	TS-99-V
3.0	TS-98-V	TS-98-V	TS-99-V	TS-99-V	TS-99-V
3.5	TS-98-V	TS-98-V	TS-98-V	TS-99-V	TS-99-V
4.0	TS-98-V	TS-98-V	TS-98-V	TS-99-V	TS-99-V
4.5	TS-98-V	TS-98-V	TS-98-V	TS-98-V	TS-99-V

TS-98-V Presetable Thermostatic Valves

7623 - Straight

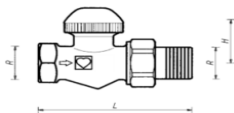
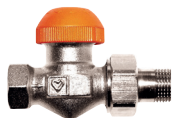

7624 - Angle

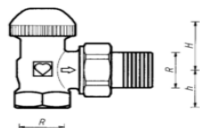
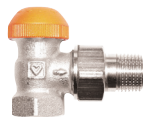

7628 - Reverse Angle

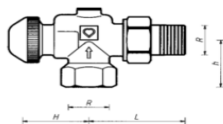
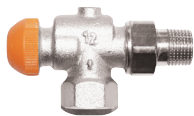

Technical data:

- Body material: Brass nickel plated
- Max operating pressure: 10 bar
- Max operating temperature: 110 °C
- Connection thread: ISO 228-1

Part number	Model	DN	R	Female Connection	L	H	h	kv
1 7623 67	Straight	15	1/2	Rp 1/2	83	27	-	1.1
1 7623 69	Straight	20	3/4	Rp 3/4	98	27	-	1.1
1 7624 67	Angle	15	1/2	Rp 1/2	54	23	23	1.2
1 7624 69	Angle	20	3/4	Rp 3/4	63	23	23	1.2
1 7628 67	Reverse Angle	15	1/2	Rp 1/2	55	35	33	1.2

TS-99-FV Presetable Thermostatic Valves

7523 - Straight

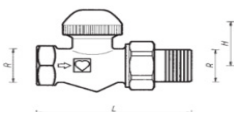
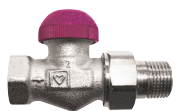

7524 - Angle

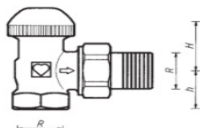
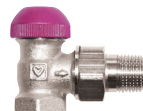

7528 - Reverse Angle

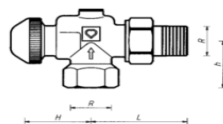

Technical data:

- Body material: Brass nickel plated
- Max operating pressure: 10 bar
- Max operating temperature: 110 °C
- Connection thread: ISO 228-1

Part number	Model	DN	R	Female Connection	L	H	h	kv
1 7523 67	Straight	15	1/2	Rp 1/2	83	27	-	0.39
1 7524 67	Angle	15	1/2	Rp 1/2	54	23	23	0.39
1 7528 67	Reverse Angle	15	1/2	Rp 1/2	55	35	33	0.39

Presetting Key for TS-98 & 99

9200



Part number	Model
1 6819 98	Presetting Key

5. RADIATOR VALVES

TS-E Single Pipe Thermostatic Valves

7723 - Straight

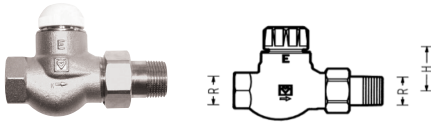

7724 - Angle

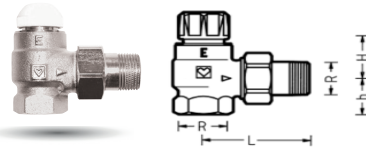

7728 - Reverse Angle

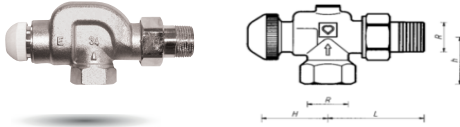

Technical data:

- Body material: Brass nickel plated
- Max operating pressure: 10 bar
- Max operating temperature: 120 °C
- Connection thread: ISO 228-1

Part number	Model	DN	R	Female Connection	L	H	h	kv
1 7723 11	Straight	15	½	Rp ½	95	43	-	5.1
1 7723 02	Straight	20	¾	Rp ¾	109	43	-	5.1
1 7723 03	Straight	25	1	Rp 1	126	43	-	5.1
1 7724 11	Angle	15	½	Rp ½	62	43	29	5.1
1 7724 02	Angle	20	¾	Rp ¾	66	35	29	5.1
1 7724 03	Angle	25	1	Rp 1	75	35	34	5.1
1 7728 11	Reverse Angle	15	½	Rp ½	74	55	35	5.1
1 7728 02	Reverse Angle	20	¾	Rp ¾	80	55	35	5.1
1 7728 03	Reverse Angle	25	1	Rp 1	82	56	59	5.1

RL1-E Single Pipe Return Valves

3723 - Straight

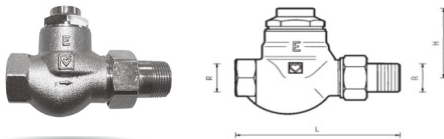

3724 - Angle

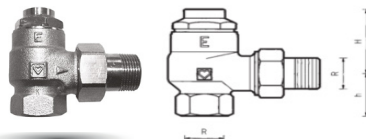

Technical data:

- Body material: Brass nickel plated
- Max operating pressure: 10 bar
- Max operating temperature: 120 °C
- Connection thread: ISO 228-1

Part number	Model	DN	R	Female Connection	L	H	h	kv
1 3723 01	Straight	15	½	Rp ½	95	43	-	4.4
1 3723 02	Straight	20	¾	Rp ¾	109	43	-	4.7
1 3723 03	Straight	25	1	Rp 1	126	43	-	5.6
1 3724 01	Angle	15	½	Rp ½	62	43	29	6.5
1 3724 02	Angle	20	¾	Rp ¾	66	35	29	8.4
1 3724 03	Angle	25	1	Rp 1	75	35	34	10.5

Bi-Directional TRV Sets - Angle/Reverse Angle

7734 - Mini Head

7734 - Std Head

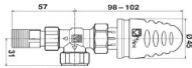
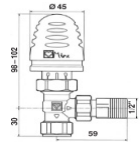

Technical data:

- Body material: Brass chrome plated
- Max operating pressure: 10 bar
- Max operating temperature: 110 °C

Domestic Use only
Not suitable for commercial projects

Part number	Model	DN	Rad Connection	Cu pipe connection
1 7734 31	Mini Sensor	15	½	10mm
1 7734 33	Mini Sensor	15	½	15mm
1 7736 10	Std Sensor	15	½	10mm
1 7736 15	Std Sensor	15	½	15mm
1 7834 15	Manual head	15	½	15mm

Domestic Return Valves

3734 - Metal Cap

3734 - Plastic Cap

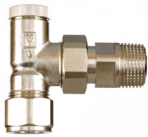

3734 - with Drain

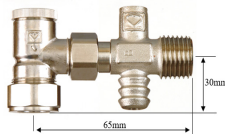

Technical data:

- Body material: Brass chrome plated
- Max operating pressure: 10 bar
- Max operating temperature: 110 °C

Part number	Model	DN	Rad Connection	Cu pipe connection
1 3734 10	Metal cap	15	½	10mm
1 3734 15	Metal cap	15	½	15mm
1 3734 31	White plastic cap	15	½	10mm
1 3734 30	White plastic cap	15	½	15mm
1 3734 25	with Drain valve	15	½	15mm

5. RADIATOR VALVES

RL1 Return Valves

3723 - Straight

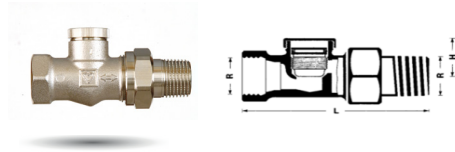

3724 - Angle

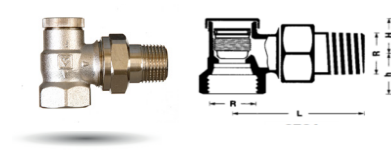

Technical data:

- Body material: Brass nickel plated
- Max operating pressure: 10 bar
- Max operating temperature: 120 °C
- Connection thread: ISO 228-1

Part number	Model	DN	R	Female Connection	L	H	h
1 3723 41	Straight	15	1/2	Rp 1/2	82	28	-
1 3723 42	Straight	20	3/4	Rp 3/4	95	27	-
1 3724 41	Angle	15	1/2	Rp 1/2	52	20	25
1 3724 42	Angle	20	3/4	Rp 3/4	60	21	27

RL5 Return Valves

3923 - Straight

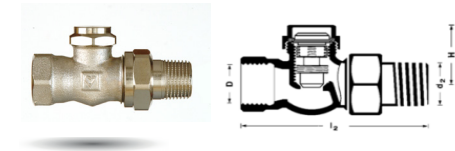

3924 - Angle

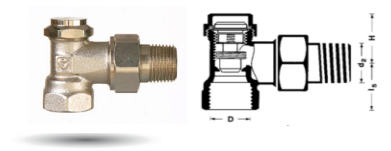

Technical data:

- Body material: Brass nickel plated
- Max operating pressure: 10 bar
- Max operating temperature: 120 °C
- Connection thread: ISO 228-1

Part number	Model	DN	d2	D	l2	l4	H	l5
1 3923 01	Straight	15	1/2	1/2	81	-	30	-
1 3923 02	Straight	20	3/4	3/4	92	-	30	-
1 3924 01	Angle	15	1/2	1/2	-	57	29	25
1 3924 02	Angle	20	3/4	3/4	-	67	29	28

RL5 Return Valves Accessories

0256



6206



6639



Part number	Description
1 0256 01	Drain valve for RL-5
1 6206 01	Hose union
1 6639 01	Presetting Key

DR-T-90 Lockshield Valves

6823 - Straight

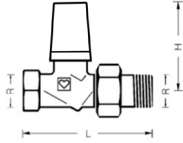

6824 - Angle

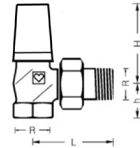

Technical data:

- Body material: Brass nickel plated
- Max operating pressure: 10 bar
- Max operating temperature: 110 °C
- Connection thread: ISO 228-1

Part number	Model	DN	R	Female Connection	L	H	h
1 6823 81	Straight	15	½	Rp ½	83	54	-
1 6823 82	Straight	20	¾	Rp ¾	98	54	-
1 6823 86	Straight	25	1	Rp1	129	85	-
1 6824 81	Angle	15	½	Rp ½	54	48	23
1 6824 82	Angle	20	¾	Rp ¾	63	48	26
1 6824 86	Angle	25	1	Rp1	76	74	41

DR-T-90 Valve Accessories

6800



6600



Part number	Description
1 6800 00	½" - ¾" Presetting Key
1 6600 00	1" - 1¼" Presetting Key

GP Lockshield Valves

5523 - Straight

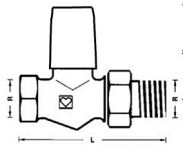

5524 - Angle

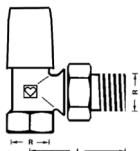

Technical data:

- Body material: Brass nickel plated
- Max operating pressure: 10 bar
- Max operating temperature: 110 °C
- Connection thread: ISO 228-1

Part number	Model	DN	R	Female Connection	L	H	h
1 5523 11	Straight	15	½	Rp ½	82	60	-
1 5523 12	Straight	20	¾	Rp ¾	95	60	-
1 5524 11	Angle	15	½	Rp ½	52	56	25
1 5524 12	Angle	20	¾	Rp ¾	60	58	27

5. RADIATOR VALVES

DR-T-90 Manual Valves

6823 - Straight

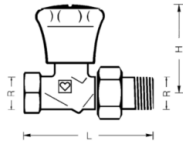

6824 - Angle

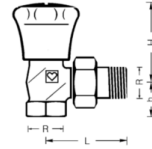

Technical data:

- Body material: Brass nickel plated
- Max operating pressure: 10 bar
- Max operating temperature: 110 °C
- Connection thread: ISO 228-1

Part number	Model	DN	R	Female Connection	L	H	h
1 6823 91	Straight	15	½	Rp ½	83	61	-
1 6823 92	Straight	20	¾	Rp ¾	98	61	-
1 6823 73	Straight	25	1	Rp 1	129	83	-
1 6824 74	Straight	32	1¼	Rp 1¼	155	117	-
1 6824 91	Angle	15	½	Rp ½	54	56	23
1 6824 92	Angle	20	¾	Rp ¾	63	56	26
1 6824 73	Angle	25	1	Rp 1	76	73	34
1 6824 74	Angle	32	1¼	Rp 1¼	90	102	41

GP Manual Valves

5523 - Straight

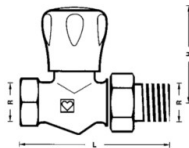

5524 - Angle

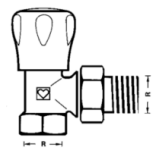

Technical data:

- Body material: Brass nickel plated
- Max operating pressure: 10 bar
- Max operating temperature: 110 °C
- Connection thread: ISO 228-1

Part number	Model	DN	R	Female Connection	L	H	h
1 5523 21	Straight	15	½	Rp ½	82	61	-
1 5523 22	Straight	20	¾	Rp ¾	95	61	-
1 5524 21	Angle	15	½	Rp ½	52	56	25
1 5524 22	Angle	20	¾	Rp ¾	60	57	27

LST Kits

9230 - Design LST



Comprising:

- 1 x Herz Design thermostatic sensor
- 1 x Angled thermostatic valve body
- 1 x Angled lockshield return valve
- 2 x Copper connection nut & olive
- 1 x Retaining nut and washer, attached to plunger and capillary assembly

9860 - Hercules



Comprising:

- 1 x Hercules thermostatic sensor
- 1 x Angled thermostatic valve body
- 1 x Angled lockshield return valve
- 2 x Copper connection nut & olive
- 1 x Retaining nut and washer, attached to plunger and capillary assembly



Part number	Model
1 9230 58	Design Sensor LST Kit
1 9860 63	Hercules Sensor LST Kit

7350



Part number	Description
1 7350 60	LST Capillary

Herz 2000 Connections

7173 - Straight

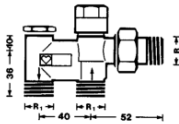
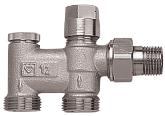

Technical data:

- Body material: Brass nickel plated
- Max operating pressure: 10 bar
- Max operating temperature: 110 °C
- Connection thread: ISO 228-1

Connections to be ordered separately see page 74



Part number	Model	DN	R	R1
1 7173 01	One pipe	15	½	G ¾
1 7175 01	Two pipe	15	½	G ¾

7728

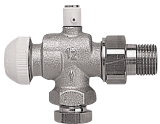

Reverse Angle Pattern with Air Vent

Part number	Size
1 7728 92	½ x 15mm

6330



15mm Connection Pipe

Part number	Length
1 6330 31	1000mm

5. RADIATOR VALVES

Deluxe Thermostatic Sensors

9230

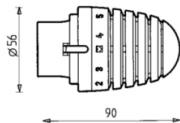

9200

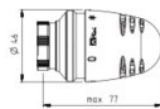

Part number	Description	Temp. range	Frost set	Mounting thread
1 9230 41	Chrome sensor	0 - 30 °C	6 °C	M28 x 1.5
1 9230 44	White RAL9010	0 - 30 °C	6 °C	M28 x 1.5
1 9230 49	Black sensor	0 - 30 °C	6 °C	M28 x 1.5
1 9200 41	Mini Chrome	0 - 30 °C	6 °C	M28 x 1.5
S 9200 34	Mini White RAL 9010	0 - 30 °C	6 °C	M28 x 1.5

Deluxe Thermostatic Valves

7923 - Straight

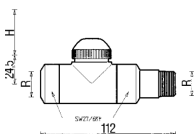

7924 - Angle

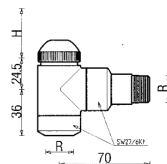

Part number	Model	Description	DN	H	R
1 7923 41	Straight	Chrome	15	Head Dim	½
1 7923 44	Straight	White RAL9010	15	Head Dim	½
1 7923 49	Straight	Black	15	Head Dim	½
1 7924 41	Angle	Chrome	15	Head Dim	½
1 7924 44	Angle	White RAL9010	15	Head Dim	½
1 7924 49	Angle	Black	15	Head Dim	½

Technical data:

- Body material: Brass nickel plated
- Max operating pressure: 10 bar
- Max operating temperature: 90 °C
- Connection thread: ISO 228-1

Deluxe Return Valves

3725 - Straight

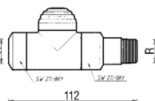

3726 - Angle

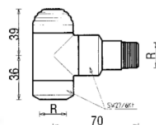

Technical data:

- Body material: Brass
- Max operating pressure: 10 bar
- Max operating temperature: 90 °C
- Connection thread: ISO 228-1

Part number	Model	Description	DN	R
1 3725 41	Straight	Chrome	15	½
1 3725 44	Straight	White RAL9010	15	½
1 3725 49	Straight	Black	15	½
1 3726 41	Angle	Chrome	15	½
1 3726 44	Angle	White RAL9010	15	½
1 3726 49	Angle	Black	15	½

Deluxe Copper Connections

6292



Order number	Description
1 6292 41	Chrome
1 6292 44	White RAL9010
1 6292 49	Black

Dynamic Thermostatic Radiator Valves

Straight

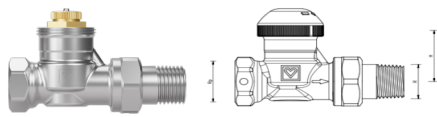

Angle

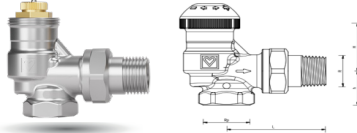

Reverse Angle

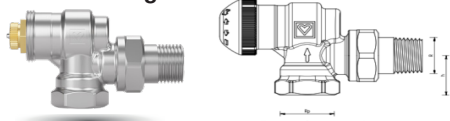

Technical data:

- Body material: Brass
- Max operating pressure: 10 bar
- Max Differential Pressure: 60 kPa
- Min Differential Pressure: 10 kPa
- Max operating temperature: 120 °C
- Connection thread: ISO 228-1

NEW!
Coming later
in 2024

Part number	Model	DN	R	Female Connection	L	H	h	kv	Flowrate l/h
1 7723 11	Straight	15	½	Rp ½	82.3	31.5	-	0.35	10 - 95
1 7724 11	Angle	15	½	Rp ½	53.3	32.5	23	0.35	10 - 95
1 7728 11	Reverse Angle	15	½	Rp ½	53.3	40.6	23	0.35	10 - 95

Radiator Valve Accessories

7780



Herz Changefix Servicing Tool

Part number	Description
1 7780 00	Changefix tool for M28x1.5
1 7781 01	Cleaning brush attachment

6807



Assembly Key

Part number
1 6807 90

6390



TS-90 Replacement Thermostatic Inserts

Part number	Size
1 6390 90	¾
1 6390 91	½
1 6390 92	¾
1 6390 93	1

6625



Multipurpose Key

Part number
1 6625 00

6367

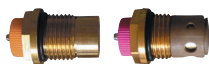

TS-98/99 Replacement Presettable Thermostatic Inserts

Part number	Description
1 6367 98	TS-98-V
1 6367 99	TS-99-FV

6680



Tailpiece Assembly Key

Part number
1 6680 00

6218

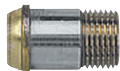

Extension Tailpiece

Part number	Length
1 6218 11	39mm
1 6218 21	42mm
1 6218 31	48mm
1 6218 41	36mm
1 6218 51	76mm

6292



Copper Connection

Part number
1 6292 01

6249



Elbow Connection

Part number	Size
1 6249 01	½"
1 6249 02	¾"

6210



Reducing Tailpiece for ¼\"/>

Part number
1 6210 12

6. DISTRIBUTION SYSTEMS

Guildford Indirect Heat Interface Unit

4018

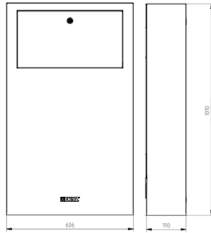

Technical data:

- UK Water Reg 4 Compliant
- Twin Heat exchangers
- DHW PT controller, tempering valve
- Primary DPCV
- Thermostatic primary temperature bypass
- Secondary flow temperature limiter
- Secondary pump & expansion vessel etc.
- HIU fully insulated including cover
- Bottom or Top entry options
- First fix rail including ball valves
- Optional heat meter & water meter



Part number	Max Primary Pressure	Max Primary Temperature	Max DHW Pressure	Max DHW Flowrate
1 4023 56	16 bar	90 °C	10 bar	20 l/min
1 4023 60	16 bar	90 °C	10 bar	26 l/min

Dublin Indirect Heat Interface Unit

4018

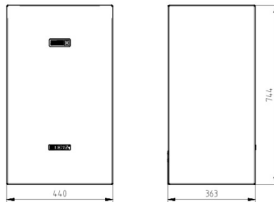

Technical data:

- UK Water Reg 4 Compliant
- Twin Heat exchangers
- DHW PT controller
- Primary DPCV
- Thermostatic primary temperature bypass
- Secondary flow temperature limiter
- Secondary pump & expansion vessel etc.
- Insulated heating pipework
- Insulated Cover
- First fix rail including ball valves
- Optional heat meter



Part number	Max Primary Pressure	Max Primary Temperature	Max DHW Pressure	Max DHW Flowrate
1 4018 75	16 bar	90 °C	10 bar	18 l/min

Ecosse Indirect Heating Heat Interface Unit

4023

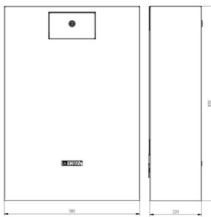

Technical data:

- HTG Heat exchanger
- Thermostatic primary temperature bypass
- Secondary flow temperature limiter
- Secondary DPCV/Zone valve
- Secondary pump & expansion vessel etc.
- HIU fully insulated including cover
- First fix rail including ball valves
- Optional heat meter



Part number	Pipe Entry	Max Primary Pressure	Max Primary Temperature	Max secondary Output
1 4023 62	Bottom	16 bar	90 °C	15 kW
1 4023 82	Top	16 bar	90 °C	15 kW

Caledonia Direct Heat Interface Unit

4023

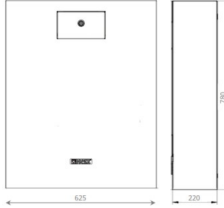

Technical data:

- UK Water Reg 4 Compliant
- DHW Heat exchanger
- DHW PT controller
- Primary DPCV
- Thermostatic primary temperature bypass
- Secondary DPC/zone valve
- HIU fully Insulated including cover
- Isolation ball valves
- Optional heat meter
- Optional MCW booster pump



Part number	MCW Pump	Max Primary Pressure	Max Primary Temperature	Max DHW Pressure	Max DHW Flowrate
1 4023 12	Installed	16 bar	90 °C	10 bar	20 l/min
1 4023 13	-	16 bar	90 °C	10 bar	20 l/min

Oxford Indirect DHW only Heat Interface Unit

4008

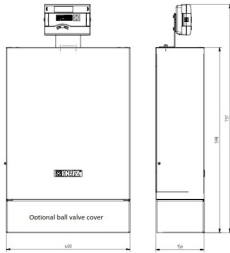

Technical data:

- UK Water Reg 4 Compliant
- DHW Heat exchanger
- DHW PT controller
- Primary DPCV
- Thermostatic primary temperature bypass
- HIU fully Insulated including cover
- Top or Bottom entry
- Isolation ball valves
- Optional heat meter & water meter



Part number	Max Primary Pressure	Max Primary Temperature	Max DHW Pressure	Max DHW Flowrate
1 4008 28	16 bar	90 °C	10 bar	20 l/min

6. DISTRIBUTION SYSTEMS

HIU First Fix Rail

4018/4021/4023



First fix rail to facilitate the installation commissioning and maintenance of Herz HIUs

Part number	Description
1 4018 96	Caledonia HIU First Fix Rail
1 4021 04	Ecosse HIU First Fix Rail
1 4023 39	Guildford HIU First Fix Rail

HIU Top Entry Bracket

4018

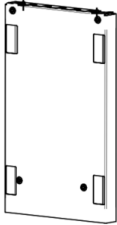

Top entry stand off bracket to allow pipes to be fed down behind the HIU

Part number	Description
1 4018 79	Guildford HIU top entry bracket
1 4023 14	Caledonia HIU top entry bracket
1 4018 76	Dublin HIU top entry bracket
1 4021 05	Ecosse HIU top entry bracket
1 4018 94	1 x Guildford HIU top entry pipe
1 4021 07	1 x Caledonia & Ecosse HIU top entry pipe

HIU Primary Flushing Bypass

4018



Can be connected to the primary flow and return ball valves to allow the HIU to be bypassed during system flushing

Part number	Description
1 4018 87	Top entry pipe connection
1 4018 88	Ball valve connection

HIU Filling Loop

HVHIUFL



UK Water Reg 4 Compliant Filling Loop for charging the space heating system

Part number	Description
HVHIUFL-01	Filling Loop 15mm connections

Solenoid Valve PN16

HVSOLV



Pilot operated Solenoid Valve for pre-payment applications. Full valve details on page 55

Part number	Description
HVSOLV-02	DN20 NC Solenoid Valve

Programmable 7 day Digital Room Thermostat can be found on page 45



HIU Presettable TRV Sets

HVHIUTRV-99

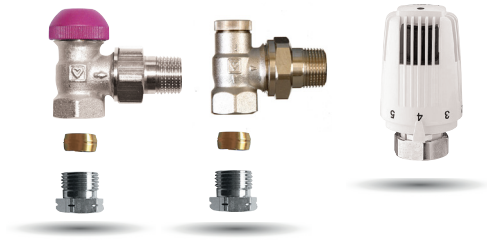

Comprising:

- 1 x Herz Classic thermostatic sensor
- 1 x Angled Presettable TS-99-FV body
- 1 x Angled Lockshield return valve
- 2 x Copper connection nut & olive

HVHIUTRV-98

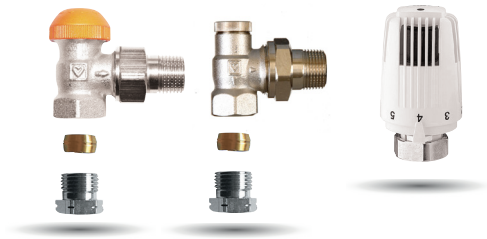

Comprising:

- 1 x Herz Classic thermostatic sensor
- 1 x Angled Presettable TS-98-FV body
- 1 x Angled Lockshield return valve
- 2 x Copper connection nut & olive

Presettable TRV and lockshield sets for HIU space heating systems

Part number	Description
HVHIUTRV-99	TS-99-FV TRV set
HVHIUTRV-98	TS-98-V TRV set

Presettable TRV Rule of Thumb

kW load	10°Δt	15°Δt	20°Δt	25°Δt	30°Δt
0.2	TS-99-V	TS-99-V	TS-99-V	TS-99-V	TS-99-V
0.5	TS-99-V	TS-99-V	TS-99-V	TS-99-V	TS-99-V
1.0	TS-99-V	TS-99-V	TS-99-V	TS-99-V	TS-99-V
1.5	TS-99-V	TS-99-V	TS-99-V	TS-99-V	TS-99-V
2.0	TS-98-V	TS-99-V	TS-99-V	TS-99-V	TS-99-V
2.5	TS-98-V	TS-98-V	TS-99-V	TS-99-V	TS-99-V
3.0	TS-98-V	TS-98-V	TS-99-V	TS-99-V	TS-99-V
3.5	TS-98-V	TS-98-V	TS-98-V	TS-99-V	TS-99-V
4.0	TS-98-V	TS-98-V	TS-98-V	TS-99-V	TS-99-V
4.5	TS-98-V	TS-98-V	TS-98-V	TS-98-V	TS-99-V

6. DISTRIBUTION SYSTEMS

Pumpfix Direct

4510/4514

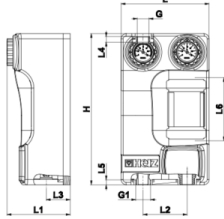

Technical data:

- Max operating pressure: 6 bar with pump, 10 bar without pump
- Max operating temperature: 110 °C
- Min operating temperature: 0 °C

Components

- Ball valves with thermometers
- Optional circulation pump
- Spacer with non-return valve
- EPP insulation



Part number	DN	Pump	kvs	L	H	L1	L2	L3	G	L4	L5	G1	L6
1 4514 11	20	No	7.8	250	390	167	125	68	¾	16	14	1	130
1 4514 12	20	Yes	7.8	250	390	209	125	68	¾	16	14	1	130
1 4510 25	25	No	20	250	430	180	125	68	1	16	12	1¼	180
1 4510 26	25	Yes	20	250	430	209	125	68	1	16	12	1¼	180
1 4514 21	32	No	28	250	430	180	125	68	1¼	16	12	1½	180
1 4514 22	32	Yes	28	250	430	209	125	68	1¼	16	12	1½	180
1 4510 05	40	No	26.4	422	845	253	180	120	2	19	25	2	220
1 4510 15	40	Yes	26.4	422	845	253	180	120	2	19	25	2	220
1 4510 06	50	No	38	422	845	253	180	120	2	19	25	2	220
1 4510 16	50	Yes	38	422	845	253	180	120	2	19	25	2	220

Pumpfix Mix

4511/4514

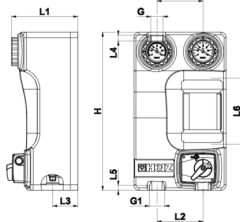

Technical data:

- Max operating pressure: 6 bar with pump, 10 bar without pump
- Max operating temperature: 110 °C
- Min operating temperature: 0 °C

Components

- Ball valves with thermometers
- Optional circulation pump
- Spacer with non-return valve
- 3 port mixing valve
- 3 point actuator



Part number	DN	Pump	kvs	L	H	L1	L2	L3	G	L4	L5	G1	L6
1 4514 14	20	No	4	250	390	186	125	68	¾	16	14	1	130
1 4514 15	20	No	6.3	250	390	186	125	68	¾	16	14	1	130
1 4514 16	20	Yes	4	250	390	209	125	68	¾	16	14	1	130
1 4514 17	20	Yes	6.3	250	390	209	125	68	¾	16	14	1	130
1 4511 44	25	No	4	250	430	186	125	68	1	16	12	1¼	180
1 4511 45	25	No	6.3	250	430	188	125	68	1	16	12	1¼	180
1 4511 46	25	No	10	250	430	193	125	68	1	16	12	1¼	180
1 4511 47	25	Yes	4	250	430	209	125	68	1	16	12	1¼	180
1 4511 48	25	Yes	6.3	250	430	209	125	68	1	16	12	1¼	180
1 4511 49	25	Yes	10	250	430	209	125	68	1	16	12	1¼	180
1 4514 24	32	No	10	250	430	193	125	68	1¼	16	12	1½	180
1 4514 25	32	No	16	250	430	193	125	68	1¼	16	12	1½	180
1 4514 26	32	Yes	10	250	430	209	125	68	1¼	16	12	1½	180
1 4514 27	32	Yes	16	250	430	209	125	68	1¼	16	12	1½	180
1 4511 78	40	No	19.8	422	845	253	180	120	2	19	25	2	220
1 4511 71	40	Yes	19.8	422	845	253	180	120	2	19	25	2	220
1 4511 79	50	No	29.5	422	845	253	180	120	2	19	25	2	220
1 4511 72	50	Yes	29.5	422	845	253	180	120	2	19	25	2	220

Pumpfix Constant

4514

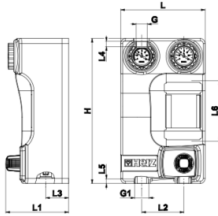

Technical data:

- Max operating pressure: 6 bar with pump, 10 bar without pump
- Max operating temperature: 110 °C
- Min operating temperature: 0 °C

Components

- Ball valves with thermometers
- Optional circulation pump
- Spacer with non-return valve
- Thermostatic 3 port valve
- Thermostatic head
- EPP insulation

Part number	DN	Pump	kvs	L	H	L1	L2	L3	G	L4	L5	G1	L6
1 4514 07	25	No	4	250	430	190	125	68	1	16	12	1¼	180
1 4514 08	25	Yes	4	250	430	209	125	68	1	16	12	1¼	180

Pumpfix Solar

4513

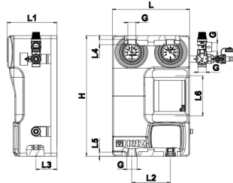

Technical data:

- Max operating pressure: 6 bar with pump, 10 bar without pump
- Max operating temperature: 110 °C
- Min operating temperature: 0 °C

Components

- Ball valves with thermometers
- Ball valves with thermometers and non-return inserts
- Optional circulation pump
- Spacer
- Air vent
- Flow meter (4-24 l/min)
- Safety valve group
- EPP insulation

Part number	DN	Pump	L	H	L1	L2	L3	G	L4	L5	G1	L6
1 4513 02	20	No	250	390	161	125	68	¾	16	14	1	130
1 4513 12	20	Yes	250	390	167	125	68	¾	16	14	1	130

Pumpfix Distributor

4501

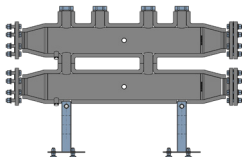

Part number	DN	Circuits	Length
1 4501 11	25	2	550
1 4501 12	25	3	800
1 4501 13	25	4	1050
1 4501 14	25	5	1300
1 4501 30	32	2	515
1 4501 31	32	3	765
1 4501 32	32	4	1015
1 4501 33	32	5	1265
1 4511 97	50	2	1173
1 4511 98	50	3	1510

6. DISTRIBUTION SYSTEMS

Valve Connection Selection Table

Size	DPCV & PICV 4002, 4006		HerzCON 4600		2, 3 & 4 port Control 7760, 7761, 7762, 7763		DPOV 4004		3 Port Valve 4037	
	Copper	Steel	Copper	Steel	Copper	Steel	Copper	Steel	Copper	Steel
DN15 Cone	1 6274 03	1 6210 21	-	-	-	-	-	-	-	-
DN15 Flat	1 6236 11	1 6220 21	1 6236 11	1 6220 21	1 6236 11	1 6220 21	1 6236 11	1 6220 21	1 6236 02	1 6221 02
DN20 Cone	1 6273 01	1 6210 02	-	-	-	-	-	-	-	-
DN20 Flat	1 6236 22	1 6220 12	1 6236 22	1 6220 12	1 6236 22	1 6220 12	1 6236 22	1 6220 12	1 6236 63	1 6220 63
DN25	1 6236 63	1 6220 63	1 6236 63	1 6220 63	1 6236 63	1 6220 63	-	-	1 6236 64	1 6220 64
DN32	1 6236 64	1 6220 64	-	-	1 6236 64	1 6220 64	-	-	1 6236 74	1 6220 74
DN40	1 6236 65	1 6220 65	-	-	-	-	-	-	1 6236 75	1 6220 75
DN50	1 6236 66	1 6220 66	-	-	-	-	-	-	1 6236 76	1 6220 76

Eurocone Compression Connections

6274/6273

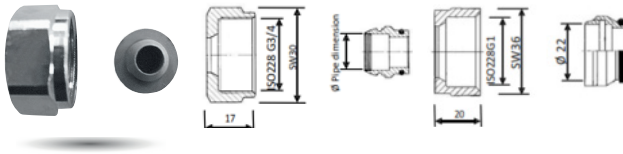

Technical data:

- DIN 3838 (Eurocone)
- Material: Nickel plated brass
- O ring: EPDM
- Max operating pressure: 10 bar
- Max operating temperature: 110 °C

Part number	Cu size	Connection	SW
1 6274 00	10mm	G 3/4	30mm
1 6274 03	15mm	G 3/4	30mm
1 6273 01	22mm	G 1	36mm

6210

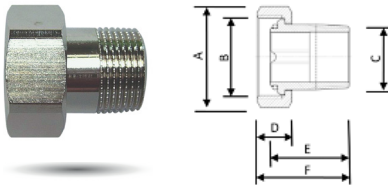

Technical data:

- DIN 3838 (Eurocone)
- Material: Nickel plated brass
- O ring: EPDM
- Max operating pressure: 10 bar
- Max operating temperature: 110 °C

Part number	Size	A	B	C	D	E	F
1 6210 21	DN15	SW 30	G 3/4	1/2	14	30	35
1 6210 02	DN20	SW 36	G 1	3/4"	16.5	36	39.5

Flat Faced Iron Connections

6220

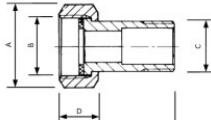

Technical data:

- DIN 3838 (Eurocone)
- Material: Nickel plated brass
- O ring: EPDM
- Max operating pressure: 10 bar
- Max operating temperature: 110 °C

Part number	Size	A	B	C	D	E	F
1 6220 21	DN15	SW 30	G ¾	½	14	25	34
1 6220 12	DN20	SW 36	G 1	¾	16.5	31	41
1 6220 63	DN25	SW 46	G 1¼	1	17.5	35	46
1 6220 64	DN32	SW 52	G 1½	1¼	22	40	62
1 6220 65	DN40	SW 60	G 1¾	1½	23	49	63.5
1 6220 66	DN50	SW 75	G 2¾	2	22.5	56	69

Flat seal connections for 4037

Part number	Size	A	B	C	D	E	F
1 6221 02	DN15	SW 36	G 1	½	16.5	32.5	43.5
1 6220 63	DN20	SW 46	G 1¼	¾	17.5	35	46
1 6220 64	DN25	SW 52	G 1½	1¼	22	40	62
1 6220 74	DN32	SW 65	G 2	1¼	22	49	62
1 6220 75	DN40	SW 75	G 2¼	1½	23	49	63
1 6220 76	DN50	SW 96	G 2¾	2	26	56	73

Flat Faced Soldered Connections

6236

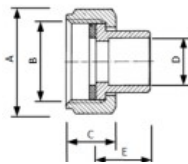

Technical data:

- DIN 3838 (Eurocone)
- Material: Nickel plated brass
- O ring: EPDM
- Max operating pressure: 10 bar
- Max operating temperature: 110 °C

Part number	Size	A	B	C	D	E	F
1 6236 11	DN15	SW 30	G ¾	14	15	17	26
1 6236 22	DN20	SW 36	G 1	16.5	22	23	34
1 6236 63	DN25	SW 46	G 1¼	17.5	28	24	35
1 6236 64	DN32	SW 52	G 1½	22	35	27	41
1 6236 65	DN40	SW 60	G 1¾	23	42	31	45
1 6236 66	DN50	SW 75	G 2¾	23	54	37	55

Flat seal connections for 4037

Part number	Size	A	B	C	D	E	F
1 6236 02	DN15	SW 36	G 1	16.5	15	18	29
1 6236 63	DN20	SW 46	G 1¼	17.5	28	24	35
1 6236 64	DN25	SW 52	G 1½	22	35	27	41
1 6236 74	DN32	SW 65	G 2	22	35	27	40.5
1 6236 75	DN40	SW 75	G 2¼	23	42	31	45.5
1 6236 76	DN50	SW 96	G 2¾	26	54	37	55

6. DISTRIBUTION SYSTEMS

Compact Heating Substation

F8800



Technical data:

- Thermal capacity: 20 kW to 4 MW
- Primary supply temperature: up to 140 °C
- Secondary supply temperature: up to 90 °C
- Primary supply nominal pressure: PN16
- Secondary supply nominal pressure: PN6

Components

- Heat exchangers
- Pressure Independent Control Valve
- Heat meter
- Strainers
- Isolation valves
- Circulation pump
- Air vents and drains
- Microprocessor control unit
- Temperature & pressure sensors

The Compact Heating Substation is designed to control the delivery of heating energy to the secondary heating system from a primary network or district heating system.

Bespoke designs.

Cooling options also available.

Part number	Description	Load
F 8800 01	Compact Heating Substation	Up to 300 kW
F 8800 02	Compact Heating Substation	Up to 600 kW
F 8800 03	Compact Heating Substation	Over 600 kW

Pressurisation Unit

DSU

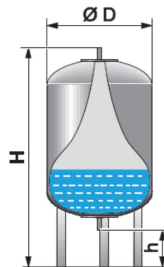

Technical data:

- Up to 2.5 MW and 10 bar
- Max operating temperature: 70 °C
- Max system temperature: 120 °C
- RS 485 communication interface
- LED indication
- Expansion tank in accordance with DIN EN 1381
- One & two pump versions

Part number 1 pump	Part number 2 pumps	Htg capacity kW	Tank vol litres	ØD	H	h
DSU-S1/A1	DSU-S1/A2	300	200	634	1060	146
DSU-S2/A1	DSU-S2/A2	340 - 500	300	634	1360	146
DSU-S3/A1	DSU-S3/A2	510 - 670	400	740	1345	133
DSU-S4/A1	DSU-S4/A2	680 - 840	500	740	1560	133
DSU-S5/A1	DSU-S5/A2	850 - 1000	600	740	1810	133
DSU-S6/A1	DSU-S6/A2	1010 - 1035	800	740	2275	133
DSU-S7/A1	DSU-S7/A2	1360 - 1690	1000	740	5685	133
DSU-S8/A1	DSU-S8/A2	1391 - 2510	1500	1200	5130	350

Commissioning Centre

CC

**Technical data:**

- Max temperature: 120 °C
- Max pressure: 16 bar
- Max no of outlets: 6

Components

- Pressure Independent Control Valve
- Fixed Orifice Commissioning Valve
- Fixed Orifice Control Valve
- Strainer
- Isolation valves
- Differential Pressure Control Valve
- DPCV Partnering valve
- Bypass ball valve
- Insulation

A manifold system enclosed in an insulated box suitable for heating or chilled applications.

Incorporating isolation valves on the flow manifold and manual or motorised commissioning valves on the return. Valves are available in DN15 to DN25 sizes and manifolds available up to 6 ports.

Commissioning centres are handed to suit.

Part number	Type	Description
CC-CS	Com Centre CS Version	FODRV & IV on ports, DPCV, strainer, drain, air vent & bypass
CC-CV	Com Centre CV Version	FOCV & IV on ports, DPCV, strainer, drain, air vent & bypass
CC-PICV	Com Centre PICV Version	PICV & IV on ports, OP, strainer, drain, air vent & bypass

UK Terms and Conditions

1. Delivery & Carriage

- 1.1 Orders over the value of £100 net Exc. VAT, on stocked items with a standard 2 to 3 day delivery (UK mainland) will incur no Carriage Charge.
- 1.2 Orders below the value of £100 net Exc. VAT, on stocked items with a standard 2 to 3 day delivery (UK mainland) will incur a £15.00 Carriage Charge.
- 1.3. Guaranteed Next Day Deliveries will be quoted separately.
- 1.4. FOHS Accredited sites are to be advised and will be quoted separately.
- 1.5. All order shortages need to be notified within 7 working days from receipt.
- 1.6. Call off orders must be completed within 3 months from the initial order date.
- 1.7. Order specific products may require a separate quotation.

2. Payment Terms

- 2.1. 30 Days Nett. Subject to our standard conditions of sale available on request.
- 2.2. Credit card payment facility available, please contact the sales office for details.
- 2.3. All new account applications will be subjected to a credit check before opening.

3. Goods Returns

- 3.1. The goods supplied by us shall remain our property until payment in full. Credit Notes are not guaranteed, they are raised when we have made a satisfactory check that the goods are re-saleable and that the return period has not been exceeded.
- 3.2. Returned goods will only be accepted with prior written consent in the form of a Return Merchandise Authorisation (RMA) generated by the Herz office which must accompany all goods returned. Any goods without an RMA generated by the Herz office will not be accepted but held for a maximum period of 4 weeks, after which they will be disposed of if paperwork is not provided in that time.
- 3.3. All items should be packaged appropriately for safe transportation, as goods damaged in transit, due to poor packaging, cannot be credited by Herz Valves UK Ltd.
- 3.4. Herz will credit the purchase price of goods provided that they are received by us unused and undamaged within 30 days of delivery and with prior written consent from the Herz office in the form of an RMA, subject to our right to levy a minimum 20% handling charge. A copy of the delivery note that accompanied the goods must also be included with the goods. The return of the goods will be at the customer's expense. No credit will be given if the goods are received after this allotted time.
- 3.5. Credit notes can only be redeemed within a period of one year from the date of issue and can only be redeemed against either a purchase order or an outstanding balance.
- 3.6. If returns are due to a Herz sales office error, then Herz Valves will arrange for collection.
- 3.7. Return of goods made to order will not be accepted in any case.

4. Warranty

- 4.1. Herz products are covered by the Herz 5 year warranty as per the Certificate of Guarantee (Customer Protection Notice) paragraph 1.2, with the exception of Herz HIUs which have a 5-year conditional warranty, the first year parts and labour, then parts only for the other 4 years, please contact the sales office for full details of the warranty conditions.
- 4.2. For clarification on any individual product warranties, please contact the sales office.
- 4.3. In the event of a proven claim on Herz Valves UK Ltd for an acknowledged product manufacturing defect, Herz will supply a replacement for the faulty products. It is the customer's responsibility to carry out the necessary replacement works.
- 4.4. The costs for any product replacement works must be agreed in writing prior to the works being carried out and are entirely at the discretion of Herz.
- 4.5. In the event that Herz agree to pay for the replacement works, evidence must be provided in the form of time sheets and receipts for any ancillary materials used etc. to support any claim. Herz reserve the right to refuse any payments that have not been agreed by prior arrangement or that are not supported by sufficiently corroborated evidence.
- 4.6. In the event that Herz agree to pay for consequential losses, any claims will only be refunded if supported by photographic or similar evidence and must be supported by genuine receipts and/or invoices for any replacement goods.
- 4.7. Herz will only refund monies for actual work carried out and under no condition will Herz enter any discussion regarding service or management costs of any description, or any markups other than actual costs.
- 4.8. Herz Valves are fully functional and fit for purpose if utilized in an external application and when operated within the temperature and pressure range of the valve, this includes external temperatures. Herz cannot be held responsible if the valves are subjected to extremes of temperature and weather conditions and should be protected and insulated from such. If fitted externally and exposed to the elements (weather conditions) some discolouration to components may occur, this should not affect the functionality of the valve.

5. Product Selection

- 5.1. Whilst great care and due diligence is taken when products are selected, against schedules or drawings, to be as accurate as possible, all quotations and valve schedules should be checked by the customer before ordering as Herz Valves UK Ltd cannot accept responsibility for errors and omissions when quoting, or for incorrectly ordered items.
- 5.2. For valves which require flow rates for sizing, if flow rates have not been provided, the valves will be selected at line size. Where flow rates have been provided, commissioning valves will be selected with a minimum signal of 1 kPa in accordance with CIBSE Code W: 2010 and BSRIA Guide BG 2/2010 Commissioning Water Systems.
- 5.3. For ultra-low flow rates where the signal is less than 1 kPa alternative commissioning techniques can be utilised as described in CIBSE Code W: 2010 and BSRIA Guide BG 2/2010 Commissioning Water Systems.

Herz Valves UK Ltd reserve the right to change design, specification and prices at any time and without prior notification.

Herz Terms and Conditions of Sale, Delivery and Payment

1. Offers, order acknowledgements, contract conclusion

- 1.1. All offers are without obligation. We reserve the right to modify, supplement or discontinue our production at any time.
- 1.2. Our written acknowledgement of order constitutes a contract, an acknowledgement of order by facsimile is sufficient also. The content of the acknowledgement of order shall at the same time be the content of the contract unless the customer raises an objection against it immediately after receipt. Otherwise, our acknowledgement of order and our Terms and Conditions of Sale, Delivery and Payment shall be deemed to have been accepted.
- 1.3. After the acknowledgement of order has been sent, the order placed with us can no longer be modified or cancelled.
- 1.4. The present Terms and Conditions of Sale, Delivery and Payment shall supersede any purchasing conditions of our customers in any case.
- 1.5. The prices are understood as ex works, unpackaged, carriage forward and without VAT.
- 1.6. In case of an increase in costs during the period between the acknowledgement of order and delivery, we shall be entitled to make the respective price adjustments.
- 1.7. In case that a component of a fitting ordered is not needed, the price deduction shall not be made according to the component price but according to our price calculation.
- 1.8. Declarations made or to be made by HERZ to our contract partners come into force once the declarations have been sent to the mailing address provided to us even if this mailing address has changed and we were not notified of this change immediately.
- 1.9. Changes and additions to this contract are only valid with written confirmation by persons at our company registered as authorised representatives in the commercial register. Our other employees are not authorised to agree on changes or ancillary agreements.

2. Conditions of Payment

- 2.1. As long as nothing else is given in the order confirmation, payments are net cash at receipt of the invoice and without any discount.
- 2.2. In the event of late payment, we reserve the right to charge interest on default in the amount of 10% above the respective Austrian bank rate per annum, however no less than 1% per month. Only payments made to the respective point of payment specified in the invoice shall be recognised by us. In the case of bank transfers, the payment is only considered made when the invoice amount has been irrevocably credited to our account.
- 2.3. Bills of exchange, cheques and payments by payment order shall only be recognised on account of payment.
- 2.4. Upon payment by acceptance or customer's bill, the arising discounting charges shall be borne by the debtor.
- 2.5. The date of the invoice shall be relevant for the date of payment in any case, even if goods are received with a delay for reasons not to be attributed to us.
- 2.6. Missing the payment deadline, loss of creditworthiness of the ordering party or other legitimate reasons entitle us, at our discretion, to withdraw from the contract or to declare all of our claims to be due immediately without consideration of the agreed payment deadline, all without hereby justifying a claim to performance or compensation for damages against us.

3. Retention of Title

- 3.1. The goods supplied by us shall remain our property until payment in full has been made for any and all goods supplied. This shall also apply to the payment of any bills of exchange accepted in payment by us. Our ownership right transfers in the event of sale by the purchaser to the proceeds obtained by the purchaser and in the event of further processing to the end product (proportionally). In the event of sale by the purchaser, the purchaser must inform its buyer of the existence of the reservation of ownership.
- 3.2. The purchaser must inform us immediately if third parties assert claims to the goods delivered under reservation of ownership or claim rights thereto. Any legal expenses shall be borne by the purchaser.

4. Packing and Dispatch

- 4.1. The goods will be packed to commercial standards at the purchaser's expense. Packing materials will not be taken back. The packing shall be dimensioned assuming customary transport conditions.
- 4.2. The goods will be dispatched ex-works at the risk of the purchaser, even in case of delivery freight prepaid.
- 4.3. The seller shall be obliged to take out insurance only if and to the extent that this has been agreed upon in writing.

5. Product Modifications

- 5.1. We reserve the right to make design modifications, to change tolerances and to make improvements.
- 5.2. In case of special designs manufactured according to customer sample, model or drawing, we reserve the right to supply up to 5% more or less than the quantity ordered.

6. Complaints

- 6.1. Defects or damage discernible during a proper receipt inspection must be reported immediately after receipt of the goods; indiscernible defects must be reported immediately after their discovery. However, any warranty claim shall expire three months after delivery.
- 6.2. Deviations in the quantity of units supplied or in weight must also be reported to the transporter or forwarding company (carrier) upon receipt of the goods and the differences must be documented. Any defective units shall be returned to us without delay freight prepaid.

7. Warranty

- 7.1. We will perform our warranty obligation by replacing free of charge any items which verifiably become entirely unusable within three months due to defective material or defective production, if the defective parts are returned within four months from delivery.

8. Returned goods

- 8.1. Returned goods shall only be accepted with our prior written consent and only carriage paid to our plant in Vienna in undamaged condition.
- 8.2. Return of items made to order will not be accepted in any case.

9. Late delivery and release from the delivery obligation

- 9.1. The obligation to deliver and to adhere to the delivery period shall be suspended by any extraordinary events and circumstances not to be attributed to us which causes a relevant interruption of operations or makes the dispatch of goods impossible.
- 9.2. In the event that dispatching of goods is impossible, we shall be entitled to store any goods already manufactured at the expense and risk of the buyer. In that case, the goods will be invoiced to the buyer as if they had already been supplied.
- 9.3. If we are late with the delivery, the purchaser must agree to a reasonable deadline extension of not less than six weeks. The purchaser is no longer entitled to withdraw from the contract – even after setting of an extended deadline – if we have already begun production of the ordered goods.

10. Quality of a Consignment

- 10.1. The quality of a consignment cannot be assessed on the basis of the quality of individual items.

11. Damages, Limitation of Warranty

- 11.1. The amount of any damages is limited according to the net invoice value of the item in question.
- 11.2. We are entitled to resolve any guarantee claims by providing replacement articles. There is no entitlement to a price reduction.
- 11.3. Demands for compensation for damages arising from installation costs, processing costs, maintenance costs, etc. shall not be accepted or compensated by us under any circumstances.
- 11.4. Claims of the customer to compensation for damages, regardless of legal basis, in particular due to late performance, impossibility of delivery, positive breach of obligation, negligence upon contract conclusion, consequential harm caused by defects, defects or prohibited actions are excluded insofar as they are not based on intent or gross negligence on our part. The existence of intent or gross negligence must be proven by the customer. Information issued by us (installation and maintenance instructions, details of areas of use for products, etc.) must be strictly adhered to. Where instructions are disregarded or ignored, the official conditions release us from any liability.
- 11.5. We accept no liability for damages arising from improper handling or use, excessive loading or natural wear. Furthermore, we do not assume liability with respect to any loss or damage caused by negligence nor any indirect or consequential loss.
- 11.6. Our liability for property damage from a product defect according to the Product Liability Act is excluded for all companies participating in the production and sale of our products as well as for all purchasers of our products, insofar as they are businesses. Our contract partners, insofar as they are businesses, accept the obligation to impose this liability disclaimer clause on their buyers, insofar as these in turn are businesses and our products are involved.

12. Place of Fulfilment and Jurisdiction

- 12.1. The place of fulfilment for all claims arising under the contract is Vienna, insofar as the goods are obtained from the plant in Vienna; if the goods are obtained from the plant in Kemetern, the place of fulfilment is Kemetern.
- 12.2. Vienna is agreed as the exclusive place of jurisdiction for all claims under the contract for contract partners from countries of the European Union as well as from countries of the European Economic Area and for contract partners registered in a country that has concluded an enforcement agreement with Austria.
- 12.3. Vienna is agreed as the place of jurisdiction for contract partners coming from countries that are not covered under item 12.2. The seller reserves the right to also assert the claim under the contract in the respective country before the respectively competent court.
- 12.4. Austrian law shall apply exclusively as subsidiary to these Terms of Sale, Delivery and Payment. The application of the Vienna UN Convention on Contracts for the International Sale of Goods is excluded.

Certificate of Guarantee

1. Definition of Terms and Scope of Validity

- 1.1. In order to be entitled to claim services under the present Certificate of Guarantee, the claiming party must hold a trade licence for the installation of low-pressure central heating systems and hot water preparation plants of the upper and lower categories or a trade licence for gas fitters and plumbers.
- 1.2. Under the present Certificate of Guarantee "Products" shall designate all heating components manufactured by us after June 1st, 2022, bought new by the party entitled to raise a claim either directly from us or directly from one of our authorized dealers in Austria, unless these components have been exempted from the validity of the Certificate of Guarantee by express declaration to the party entitled to raise a claim or are generally exempted from such guarantee. There are special provisions for electronic and electric products such as HERZ electronic thermostats and actuating drives, HERZ actuating drives, HERZ room temperature controllers, HERZ transformers and wireless control systems and devices, which are not covered by the Certificate of Guarantee. Furthermore, wear parts of HERZ components such as seals are not covered by the present Certificate of Guarantee.
- 1.3. A case of damage in the sense of the Certificate of Guarantee occurs when a customer of a party entitled to raise claims with HERZ raises a warranty claim against the said party for any damage caused by an error in design or a defect in manufacturing or materials of the products.
- 1.4. The geographic validity of the Certificate of Guarantee shall be limited to places within Europe and Turkey.

2. Extent of Services rendered under the Certificate of Guarantee

We shall render the following services under the present Certificate of Guarantee (excluding any further claims):

- 2.1. Replacement free of charge of the products or product components required for repairing the damage, postage paid to claim location.
- 2.2. At our discretion:
 - a) performing the required dismantling /disassembly and assembly/ installation of products or product components or
 - b) repairing the original product or product components or
 - c) paying the costs for the services as mentioned above.
- 2.3. Repairing the immediate material damage caused by the defective products or paying the costs for the services as mentioned above.
- 2.4. Reimbursement of the direct personal injury costs caused by the products.
- 2.5. Our liability according to 2.1. to 2.3. is limited to €500,000.00 per claim.
- 2.6. Without prejudice to the provisions of item 4.1. our liability shall be limited in terms of time to claims arising within a period of 5 years after manufacturing of the products causing the damage.

- 2.7. Our liability is limited to claims arising out of errors in design, defects in manufacturing or materials of the products and based on the absence of characteristics which have either been guaranteed by us or which can be expected in accordance with the state of technology or with trade practice.

3. Obligations of the Party Entitled to Raise Claims

It is a condition precedent for the implementation of the present Certificate of Guarantee that the party entitled to raise claims meet the below mentioned obligations. Failure to meet any or several of these obligations shall relieve HERZ of any and all obligations under the present Guarantee.

- 3.1. During installation and use of the products it is imperative to observe our instructions for installation and maintenance valid at the moment of installation and laid down in the brochures, standard sheets, as well as our information regarding the scope of application of the products. Furthermore, it is imperative to proceed with due care according to the state of technology, particularly during maintenance.
- 3.2. As soon as the party entitled to raise a claim detects or learns of a case of damage, it shall forthwith inform HERZ of such damage (not later than on the 3rd working day thereafter) by certified mail or email and shall make available to us all information requested by us. The information shall be submitted in writing upon our request.
- 3.3. The party entitled to raise a claim shall make sure that the representatives of our company and the agents of our insurance company be granted access to the place of damage immediately after giving notice of the claim and shall take all appropriate measures to determine the cause and scope of the damage. In particular, the party entitled to raise a claim shall keep and make available the products or product components which caused the damage.
- 3.4. The burden of proof lies on the injured party. The eligible party may not either in our name or in its own name recognise an obligation to provide compensation for damages, either in terms of basis or amount. Any declaration extending the scope of damages offered by the present Certificate of Guarantee and by the applicable legal provisions made by the party entitled to raise a claim before or after the occurrence of damage, are not permitted and shall not be binding on us.

4. Period of validity and formal provisions

- 4.1. The present Certificate of Guarantee shall cover claims for damage occurring between October 1st, 2022 and September 30th, 2026. We reserve the right to extend this period.

5. Place of Fulfilment, Jurisdiction, Applicable Law

- 5.1. The place of fulfilment shall be Vienna. The court having subject-matter jurisdiction for our company in Vienna shall have exclusive jurisdiction. Any disputes arising from the present Certificate of Guarantee shall be settled according to Austrian Law. The application of the Vienna UN Convention on Contracts for the International Sale of Goods is excluded.

Vienna, October 2022



Certifications and Approvals



ISO 9001 Certification

HERZ Armaturen Ges.m.b.H., A-1230V Vienna, has an effective quality management system in all divisions of the business, suitable for upholding all-important trust from customers. Proof has been furnished that the requirements according to **ÖNORM EN ISO 9001:2000** are fulfilled.



ISO 14001 Certification

HERZ Armaturen Ges.m.b.H., A-1230V Vienna, has an effective environmental management system in all divisions of the business, suitable for upholding all-important trust from customers. Proof has been furnished that the requirements according to **ÖNORM EN ISO 14001:2009-11** are fulfilled.



WRAS Approval

Several Herz products have been tested and are in compliance with Regulation 4(1)a of the Water Supply (Water Fittings) Regulations 1999 England & Wales; 2009 Northern Ireland and 2014 Byelaws Scotland.



KIWA Approval

Several Herz products have been tested and are in compliance with Regulation 4(1)a of the Water Supply (Water Fittings) Regulations 1999 England & Wales; 2009 Northern Ireland and 2014 Byelaws Scotland.



CE or UKCA Marking

All Herz Valves covered by this Product Guide Price List are in accordance with the requirements of the relevant directives and are either CE or UKCA marked accordingly or are covered by SEP (Sound Engineering Practice) and do not require marking.

UK Water Regulation 4 compliance

The Water companies are sole enforcers of the Water Supply (Water Fittings) Regulations 1999 and responsible for determining Regulation 4 compliance.

Historically in the UK, WRAS Approval has been the only approvals scheme demonstrating compliance with UK Water Regulation 4. Water fittings are tested in two ISO/IEC 17025 UKAS accredited laboratories (KIWA and NSF) and approved by WRAS to be compliant to Reg 4.

More recently, the two test laboratories that conduct the tests for WRAS Approval have developed their own approval schemes for demonstrating compliance with UK Water Regulation 4. They are the KIWA UK Product Approval Scheme (KUKreg4) and the NSF REG4 Certification Scheme. Both certification schemes comply with the ISO/IEC 17065 product certification scheme and are accepted by industry stakeholders.

It is no longer correct to refer to WRAS Approval as the only indicator of Regulation 4 compliance as there are three approvals bodies, the correct terminology is **UK Water Regulation 4 compliant** and this would encompass the three approvals which each carry equal weight.

WRAS Approval



KUKreg4 Approval



NSF REG4 Approval



Water Fittings Requirement

Manufacturers and distributors of sanitary and plumbing products and components intended for installation in the UK, have to ensure that their products are compliant with Regulation 4 of the Water Supply (Water Fittings) Regulations 1999 England & Wales; 2009 Northern Ireland and 2014 Byelaws Scotland.

Regulation 4 specifically sets out rules for water fittings, as follows:

Part 1: Every water fitting shall:

- Be of an appropriate quality and standard.
- Be suitable for the circumstances in which it is used.

Part 2: For the purposes of this regulation, a water fitting is of an appropriate standard or quality only if:

- It bears an appropriate CE Mark.
- It conforms to an appropriate harmonised standard.
- It conforms to an appropriate British Standard.
- It conforms to a specification approved by the regulator.

Part number Index

Order number	Page number	Order number	Page number	Order number	Page number
1 0256	62	1 4600	18, 19	1 9200	56, 66
1 0284	20	1 4700	18	1 9230	56, 65, 66
				1 9260	56
1 2117	45	1 5523	63, 64	1 9330	17, 57
1 2190	22, 23, 46	1 5524	63, 64	1 9430	57
1 2206	24, 47, 48			1 9460	57
1 2300	36	1 6206	17, 62	1 9551	56
1 2512	34	1 6210	9, 12, 16, 67, 76	1 9554	57
1 2604	35	1 6218	67	1 9860	57, 65
1 2605	35	1 6220	8-12,16,40-44,76,77	1 9861	57
1 2606	35	1 6221	44, 76, 77		
1 2607	35	1 6236	8-12,16,40-44,76,77	21266	36
1 2608	35	1 6249	71	21446	36
1 2609	35	1 6273	9, 12, 16, 76		
1 2610	35	1 6274	9, 12, 16, 76	2 4011	48
1 2611	35	1 6292	66, 67		
1 2612	35	1 6313	40	3 F799	44, 45
1 2613	35	1 6330	65		
1 2615	35	1 6367	67	4 2622	32
1 2618	35	1 6390	67	4 4111	30
1 2622	31	1 6600	63		
1 2630	33	1 6625	67	C 2190	38
1 2647	35	1 6639	62	C 2662	38
1 2657	35	1 6680	67	C 4011	38, 48
1 2662	30, 54	1 6800	63	C 4017	37
1 2667	35	1 6807	67	C 6251	39
1 2669	35	1 6819	59	C 6252	39
1 2670	21	1 6823	63, 64		
1 2682	50	1 6824	63, 64		
1 2687	35			F 4006	14
1 2689	35	1 7173	65	F 4007	10
1 2697	35	1 7175	65	F 4035	43
		1 7217	41	F 4037	43
1 3723	60, 62	1 7230	56	F 7712	15
1 3724	60, 62	1 7260	56	F 8800	74
1 3725	67	1 7262	56		
1 3726	67	1 7350	65	HV185W	54
1 3734	61	1 7420	40	HV2740	6
1 3923	62	1 7421	40	HV2879	34
1 3924	62	1 7523	59	HV5150	27
		1 7524	59	HV5154CXC	27
1 4000	5	1 7528	59	HV5516	25
1 4002	8, 9, 21	1 7623	59	HV5520	25
1 4004	35	1 7624	59	HVACT	11
1 4006	11, 12	1 7628	59	HVADS	33
1 4007	21	1 7708	13, 17	HV-BF-FLG	29
1 4008	69	1 7712	44, 45	HV-BF-FLL	29
1 4017	4, 37	1 7723	41, 58, 60	HVCH25	31
1 4018	68, 70	1 7724	58, 60	HVDCV	53
1 4021	70	1 7728	58, 60, 65	HVDCVC	53
1 4023	68, 69, 70	1 7734	61	HVHIUFL	70
1 4037	44	1 7736	61	HVHIUTRV	71
1 4111	30	1 7748	58	HVPRVC	50
1 4112	26	1 7758	58	HVPRVF	51
1 4113	26	1 7759	58	HVSBV	47
1 4119	34	1 7760	42	HVSCV	52
1 4217	5, 9	1 7761	40	HVSCVC	52
1 4218	6, 7, 10	1 7762	42	HVSOLV	55, 70
1 4219	28	1 7763	42	HVTMV	47
1 4406	12	1 7780	67		
1 4500	16, 17	1 7781	67	I 1124	33
1 4501	73	1 7834	61		
1 4510	72, 74	1 7923	66	S 9200	66
1 4511	72	1 7924	66		
1 4513	73	1 7990	13		
1 4514	72, 73, 74			TMVBV15FR	47
		1 8900	20		

HERZ Valves UK Ltd.

Unit 2B Centurion Business Park,
Sturrock Way, Bretton,
Peterborough
PE3 8YF
Telephone: 01733 300330

E-mail: sales@herzvalves.com
www.herzvalves.com

